

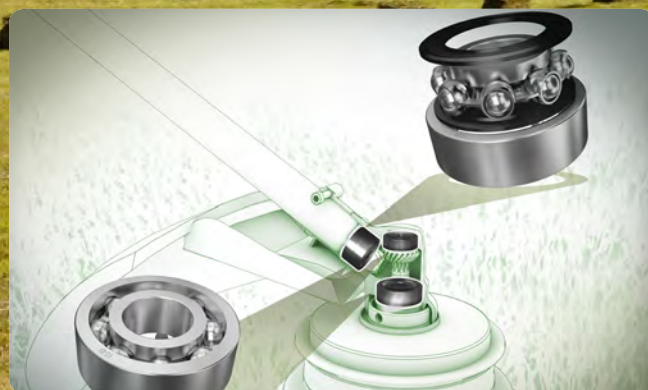

COMPANY WITH
QUALITY SYSTEM
CERTIFIED BY DNV GL
= ISO 9001 =

I N D U S T R I E S
B E A R I N G S & C O M P O N E N T S

AGRICULTURAL PRODUCTS ***PRODOTTI AGRICOLI***



GENERAL TECHNICAL CATALOGUE
CATALOGO TECNICO GENERALE



01.10.18
www.isb-bearing.com

AGRICULTURAL RANGE

GAMMA AGRICOLA

Products for agricultural and gardening machinery

Prodotti per macchine agricole e giardinaggio



Ball Bearings
Cuscinetti a sfere



Agricultural Bearings
Cuscinetti Agricoli



Agri Hub
Cuscinetti per frangizolle



Agricultural Slewing Bearings
Ralle agricole



Tapered Roller Bearings
Cuscinetti a rulli conici



Self-aligning bearings
Supporti autoallineanti



Pressed steel bearing units -
Bearings for units
*Supporti in lamiera stampata -
Cuscinetti per supporti*



Spherical plain bearings, rod ends,
clevises
Snodi sferici, teste a snodo, forcelle



Bushes
Boccole



Needle Bearings, PWTR
Stud type track rollers, NUKR
*Cuscinetti a rullini, PTWR
Perni folli, NUKR*



Shaft seals - Metallic seals
Anelli di tenuta - Tenute metalliche



Sleeves and accessories
Bussole e accessori

■ HEAD OFFICE
SEDE PRINCIPALE



■ WAREHOUSE
MAGAZZINO

■ SALES DEPARTMENT
UFFICIO COMMERCIALE



ISB Bearing China (Shanghai) Co., Ltd.

ISB Bearing India Pvt. Ltd.

ITALCUSCINETTI S.p.A. a Socio Unico - C.F. e P.I. CEE IT 00966080350
Via Caponnetto, 15 - 42048 Rubiera (Reggio Emilia) ITALIA
ITALIA Tel. +39 0522 621811 - comm.it@italcuscinetti.it
EXPORT Tel. +39 0522 621830 - export@italcuscinetti.it
R.E.A. C.C.I.A.A. RE 153325 - Capitale Sociale € 1.000.000 i.v.
info@italcuscinetti.it - www.italcuscinetti.it

艾斯比轴承上海有限公司 - Building 8 No. 860 Zhongde Road
Dagang Town, Songjiang District - Shanghai 201616 (People's Republic of China)
Tel. 0086 021 5988 5302 - Fax 0086 021 5988 5305 - info@italbearings.cn

Production control - Controllo processo produttivo



INDUSTRIES
BEARINGS & COMPONENTS

www.isb-bearing.com

GENERAL SALES PROGRAM

PROGRAMMA GENERALE DI VENDITA



Components for linear motion *
*Componenti per la
movimentazione lineare **



Bearings and components *
*Cuscinetti e componenti **



Super precision bearings *
*Cuscinetti di super precisione **



ELECTRICAL MOTORS STANDARD

Bearings for "low noise" applications *
*Cuscinetti per applicazioni
"bassa rumorosità" **

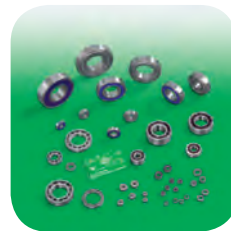

Slewing bearings *
*Cuscinetti di base **



Needle bearings *
*Cuscinetti a rullini **



**Spherical plain bearings
rod ends - clevises ***
*Snodi sferici
teste a snodo - forcelle **



Self-aligning bearing units *
*Supporti autoallineanti **



Free wheels *
*Ruote libere **



Bushes *
*Boccole **

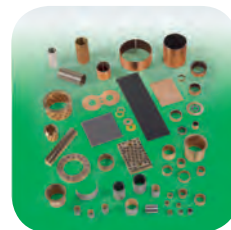

**Bearings and Self-aligning
bearing units ***
*Cuscinetti e supporti
autoallineanti **



Products in stainless steel
Prodotti in acciaio inox

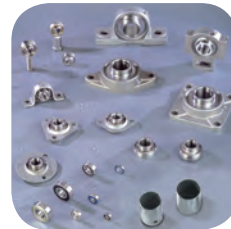

* For further information, please ask for technical catalogue, also available on line: www.isb-bearing.com

* Per ulteriori informazioni, potete richiedere il catalogo tecnico, disponibile anche on line: www.isb-bearing.com



GENERAL TECHNICAL CATALOGUE
CATALOGO TECNICO GENERALE

Distributor / Distributore



I N D U S T R I E S
BEARINGS AND COMPONENTS

INDEX

INDICE

Agricultural bearings..... pag. 5
Cuscinetti agricoli

Special bearings..... pag. 23
Cuscinetti speciali

Agri Hub..... pag. 29
Cuscinetti per frangizolle

Agricultural slewing bearings..... pag. 37
Ralle agricole





INDUSTRIES
BEARINGS & COMPONENTS

AGRICULTURAL BEARINGS *CUSCINETTI AGRICOLI*



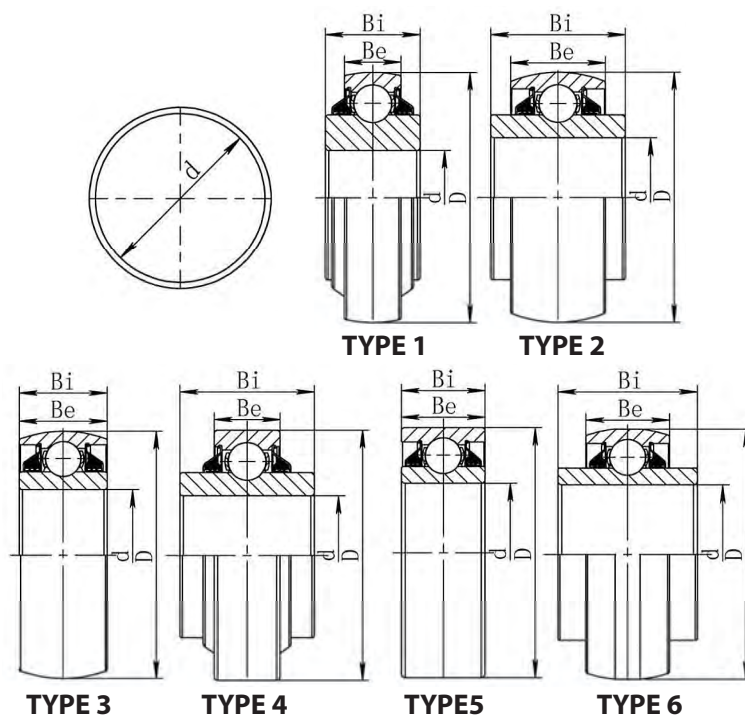

Designation <i>Sigla</i>	Type <i>Tipo</i>	Dimensions - <i>Dimensioni</i>				Bearings interchange <i>Intercambiabilità cuscinetti</i>		
		d	D	Be	Bi			
		[inch]				BCA	LINK-BELT	NTN
W208PPB2	1	1.5005 38.113	3.1496 80.000	0.7090 18.000	1.6880 42.875		24R6-208E3	2AC08-1 1/2
W208PPB7	2	1.1880 30.175	3.1496 80.000	0.7090 18.000	1.1880 30.175	DS208TT7	19R208E3	1AC08-1 3/16
W208PP10	4	1.5005 38.113	3.1496 80.000	0.8270 21.000	1.6880 42.875	DC208TT10	24RB8-208E3	
W208PPB10	1	1.5005 38.113	3.1496 80.000	0.8270 21.000	1.6880 42.875			
W208PPB23	2	1.5005 38.113	3.1496 80000	1.1880 30.175	1.6880 42.875	DS208TT2A		
W209PPB2	3	1.7717 45.000	3.3460 85.000	1.1880 30.175	1.1880 30.175	DS209TT2	R3-209E3	
W209PPB4	3	1.5350 39.000	3.3460 85.000	1.1880 30.175	1.1880 30.175	DS209TT4	24R3-209E3	3AC09-1/2
W210PP2	5	1.9380 49.225	3.5433 90 000	1.1880 30.175	1.1880 30.175	DC210TT2	31 RB3-210E3	7AC10-1 15/16
W210PP2	3	1.9380 49.225	3.5430 90.000	1.1880 30.175	1.1880 30.175	DS210TT2	31R3-210E3	3AC10-1 15/16
W210PPB2	3	1.7850 45.339	3.5430 90.000	1.1880 30.175	1.1880 30.175	DS210TT5	28R3-210E3	3AC10-1 3/4
W210PP8	5	1.5300 38.862	3.5433 90.000	1.1880 30.175	1.1880 30.175			
W210PPB8	2	1.9448 49.400	3.5433 90.000	0.9055 23.000	1.4382 36.530			
W211PP2	5	2.1880 55.575	3.9370 100.000	1.3120 33.325	1.3120 33.325	DC211TT2	35RB3-211E3	7AC11-2 3/16
W211PPB2	3	2.1880 55.575	3.9370 100.000	1.3120 33.325	1.3120 33.325	DS211TT2	35R3-211E3	3AC11 2 3/16
W211PPB4	6	2.1880 55.575	3.9370 100.000	1.3120 33.325	2.1870 55.500	DS211TT4		
W214PP2	5	2.7559 70.000	4.9213 125,000	1.5620 39.675	1.5620 39.675			
W214PPB2	3	2.7559 70.000	4.9213 125.000	1.5620 39.675	1.5620 39.675			
W214PPB9	3	2.7660 70.256	4.9213 125.000	1,1020 28.000	1.7500 44.450			

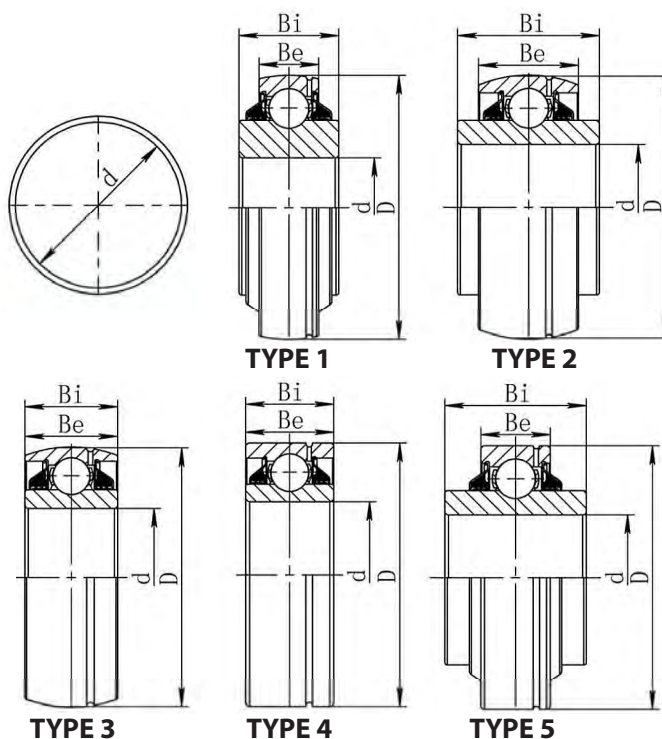

Designation <i>Sigla</i>	Type <i>Tipo</i>	Dimensions - <i>Dimensioni</i>				Bearings interchange <i>Intercambiabilità cuscinetti</i>		
		d	D	Be	Bi	BCA	LINK-BELT	NTN
		[inch]						
GW209PPB2	3	1.7717 45.000	3.3465 85.000	1.1880 30.175	1.1880 30.175	DS209TTR2	RG3-209E3	3AC09D1
GW209PPB4	3	1.5350 39.000	3.3465 85.000	.8660 22.000	1.1880 30.175	DS209TTR4	24G3-209E3	3AC09 1 1/2 D1
GW209PPB11	1	1.7810 45.237	3.3465 85.000	1.1880 30.175	1.4380 36.525	DS209TTR10		1AC09D1V1
GW210PPB2	3	1.9380 49.225	3.5433 90.000	1.1880 30.175	1.1880 30.175	DS210TTR2	31 RG3-210E3	3AC10-1 13/16 D1
GW210PPB5	3	1.7850 45.339	3.5433 90.000	1.1880 30.175	1.1880 30.175	DS210TTR5R		
GW210PP9	5	1.9450 49.403	3.5433 90.000	.9060 23.000	1.4380 36.525			
GW211PP2	4	2.1880 55.575	3.9370 100.000	1.3120 33.325	1.3120 33.325	DC211TTR2		
GW211PPB2	3	2.1380 55.575	3.9370 100.000	1.3120 33.325	1.3120 33.325	DS211TTR2		
GW211PPB8	1	2.1880 55.575	3.9370 100.000	.9840 25.000	1.3120 33.325			
GW211PPB9	1	2.1950 55.753	3.9370 100.000	.9840 25.000	1.5620 39.675	DS211TTR9		
GW211PPB10	3	1.9380 49.225	3.9370 100.000	1.3120 33.325	1.3120 33.325			
GW211PPB13	1	1.7850 45.339	3.9370 100.000	.9840 25.000	1.3120 33.325	DS211TTR13		
GW211PPB14	1	2.0150 51.181	3.9370 100.000	.9840 25.000	1.3120 33.325			
GW211PP25	5	1.7800 45.212	3.9370 100.000	1.3120 33.325	1.7500 44.450	DC211TTR21		
GW214PP2	4	2.7559 70.000	4.9213 125.000	1.5620 39.675	1.5620 39.675	DC214TTR2		
GW214PPB2	3	2.7559 70.000	4.9213 125.000	1.5620 39.675	1.5620 39.675			3AC1401
GW214PPB3	3	1.9380 49.225	4.9213 125.000	1.5620 39.675	1.5620 39.675	DS214TTR3		
GW214PPB5	2	2.7559 70.000	4.9213 125.000	1.5620 39.675	2.4380 61.925	DS214TTR5		
GW214PPB6	1	2.6881 68.278	4.9213 125.000	1.1024 28.000	2.6875 68.263	DS214TTRA		

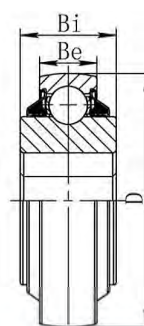
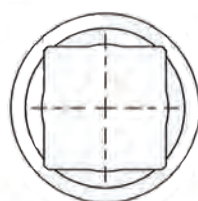
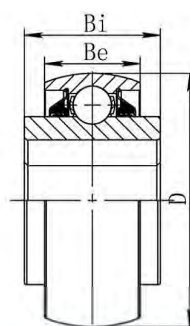
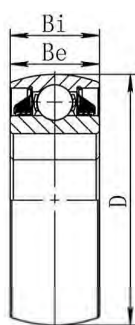
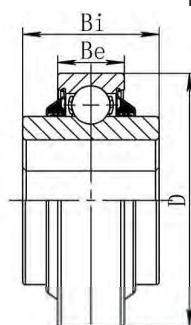
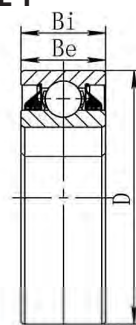
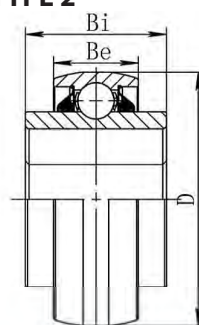
TYPE 1

TYPE 2

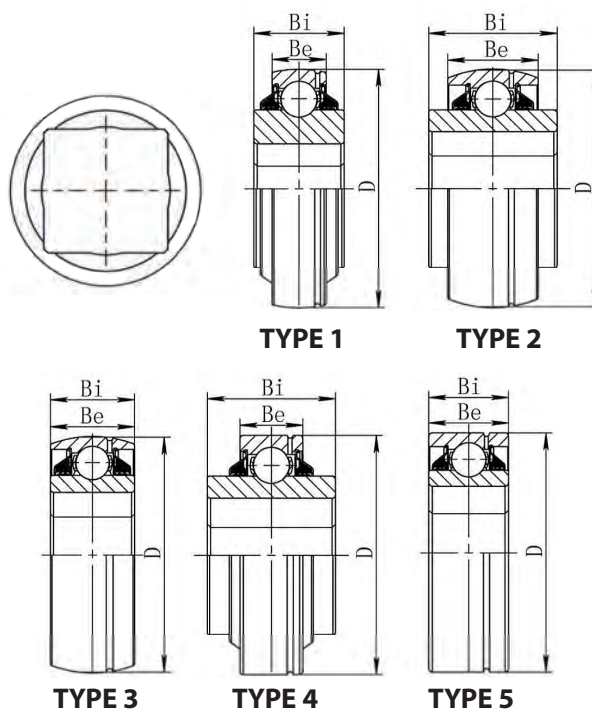
TYPE 3

TYPE 4

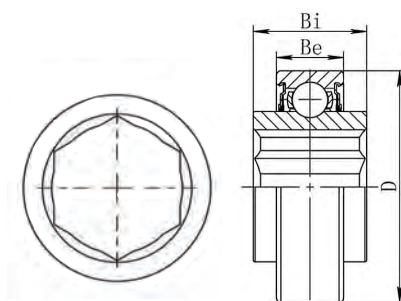
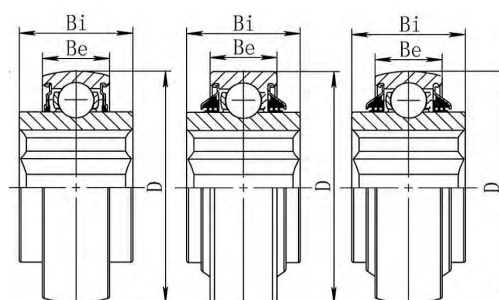
TYPE 5

TYPE 6

Designation <i>Sigla</i>	Type <i>Tipo</i>	Dimensions - <i>Dimensioni</i>				Bearings interchange <i>Intercambiabilità cuscinetti</i>		
		d	D	Be	Bi			
		[inch]				BCA	LINK-BELT	NTN
W208PP5	4	1.1800 29.970	3.1496 80.000	0.7090 18.000	1.4380 36.520	0C208TT5	18SB5-2E08E3	5AS08-1 1/8
W208PPB5	1	1.1800 29.970	3.1496 80.000	0.7090 18.000	1.4380 36.520	0S208TT5	18S5-2E08E3	1AS08-1 1/8
W208PP6	4	1.0300 26.162	3.1496 80.000	0.7090 18.000	1.4380 36.520	DC208TT6	16SB5-208E3	
W208PPB6	1	1.0300 26.162	3.1496 80.000	0.7090 18.000	1.4380 36.520	DS208TT6	16S5-208E3	1AS08-1
W208PP8	4	1.1800 29.972	3.1496 80.000	1.1880 30.175	1.4380 36.520	DC208TT8	18SB2-2E08E3	6AS09-1 1/8
W208PPB8	2	1.1800 29.972	3.1496 80.000	1.1880 30.175	1.4380 36.520	DS208TT8	18S2-2E08E3	2AS08-1 1/8
W208PPB9	2	1.0300 26.162	3.1496 80.000	1.1880 30.175	1.4380 36.520	DS208TT9	16S2-208E3	2AS08-1 1/8
W208PPB11	6	.9050 23 000	3.3760 85.750	1.1880 30.175	1.4380 36.520	DS208TT11	14S4-208E3	4AS08-7/8
W208PPB12	6	1.1800 29.972	3.3760 85.750	1.1880 30.175	1.4380 36.520	DS208TT12	18S4-2E08E3	4AS08-1 1/8
W208PPB13	1	.9050 23 000	3.1496 80.000	0.7090 18.000	1.4380 36.520	0S208TT13	14S5-208E3	1AS08-7/8
W209PPB5	2	1.2900 32.766	3.3465 85.000	1.1880 30.175	1.4380 36.520	DS209TT5	20S2-209E3	2AS09-1 1/4
W209PPB7	6	1.2900 32.766	3.3760 85.750	1.1880 30.175	1.4375 36.510	DS209TT7	20S4-209E3	
W210PP4	5	1.1800 29.972	3.5433 90.000	1.1880 30.175	1.1880 30.150	DC210TT4	18SB3-210E3	7AS10-1 1/8
W210PPB4	3	1.1800 29.972	3.5433 90.000	1.1880 30.175	1.1880 30.175	DS210TT4	18S3-210E3	3AS10-1 3/4
W210PPB6	2	1.1800 29.972	3.5433 90.000	1.1880 30.175	1.4380 36.520	DS210TT6	18S2-210E3	2AS10-1 1/8
W211PP3	5	1.5311 38 890	3.9370 100.000	1.3120 33.324	1.3120 33.324	DC211TT3	24SB3-211E3	7AS11-1 1/2
W211PPB3	3	1.5311 38.890	3.9370 100.000	1.3120 33.324	1.3120 33.324	0S211TT3	24S3-211 E3	3AS11-1 1/2
W211PP5	4	1.5311 38.890	4 0000 101.600	1.4380 36.520	1.7500 44.450	DC211TT5		6AS11-1 1/2 V1
W211PPB6	6	1.5311 38.890	4.0770 103.556	1.4380 36.520	1.7500 44.450	DS211TT6		4AS11-1 1/2



Designation <i>Sigla</i>	Type <i>Tipo</i>	Dimensions - <i>Dimensioni</i>				Bearings interchange <i>Intercambiabilità cuscinetti</i>		
		d	D	Be	Bi			
		[inch]				BCA	LINK-BELT	NTN
GW208PPB5	1	1.1800 29.970	3.1496 80.000	0.7090 18.000	1.4380 36.520	DS208TTR21	18SG7-2E08E3	1AS08-1 5/3201
GW208PPB6	1	1.1800 29.970	3.1496 80.000	0.7090 18.000	1.4380 36.520	DS208TTR6	16SG7-208E3	
GW208PPB8	2	1.0300 26.162	3.1496 80.000	0.7090 18.000	1.4380 36.520	18SG2-2E08E3	2AS08-1 1/8 01	
GW208PP17	4	1.0300 26.162	3.1496 80.000	0.7090 18.000	1.4380 36.520	DC208TTR17		
GW208PPB17	2	1.1800 29.972	3.1496 80.000	1.1880 30.175	1.4380 36.520			
GW209PPB5	2	1.1800 29.972	3.1496 80.000	1.1880 30.175	1.4380 36.520	DS209TTR5		
GW209PPB8	1	1.0300 26.162	3.1496 80.000	1.1880 30.175	1.4380 36.520	DS209TTR8	20SG5-209E3	
GW210PP4	5	.9050 23 000	3.3760 85.750	1.1880 30.175	1.4380 36.520	DC210TTR4	18SBG3-210E3	7AS101 1/8 01
GW210PPB4	3	1.1800 29.972	3.3760 85.750	1.1880 30.175	1.4380 36.520	DS210TTR4	18SG3-210E3	
GW211PP3	5	.9050 23 000	3.1496 80.000	0.7090 18.000	1.4380 36.520	DC211TTR3	24SBG3-211E3	7AS11-1 1/2 01
GW211PPB3	3	1.2900 32.766	3.3465 85.000	1.1880 30.175	1.4380 36.520	DS211TTR3	24SG3211E3	3AS11-1 1/2 D1
GW211PP5	4	1.2900 32.766	3.3760 85.750	1.1880 30.175	1.4375 36.510			
GW211PP17	4	1.1800 29.972	3.5433 90.000	1.1880 30.175	1.1880 30.150	DC211TTR3E		
GW211PPB17	1	1.1800 29.972	3.5433 90.000	1.1880 30.175	1.1880 30.175			
GW214PPB4	3	1.1800 29.972	3.5433 90.000	1.1880 30.175	1.4380 36.520			3AS14-2D1
GW216PP2	4	1.5311 38 890	3.9370 100.000	1.3120 33.324	1.3120 33.324			

TYPE 1

TYPE 2
TYPE 3
TYPE 4

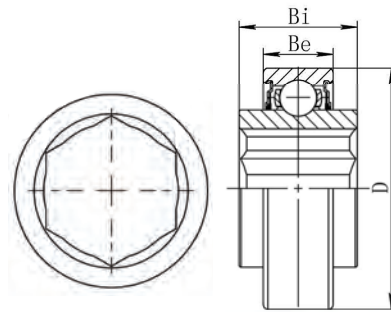
Designation <i>Sigla</i>	Type <i>Tipo</i>	Dimensions - <i>Dimensioni</i>				Bearings interchange <i>Intercambiabilità cuscinetti</i>		
		d	D	Be	Bi	BCA	LINK-BELT	NTN
		[inch]						
202KRR3	1	0.5630	1.3780	0.4330	0.5120			
		14.300	35.000	11.000	13.000			
204KPP2	3	0.6950	1.8504	0.5510	0.8250			
		17.653	47.000	14.000	20.955			
204KRR2	1	0.6950	1.8504	0.5510	0.8250	HPC011GP	11KB204N	1AH04-11/16
		17.653	47.000	14.000	20.955			
204KRRB2	2	0.6950	1.8504	0.5510	0.8250		11K204N	
		17.653	47.000	14.000	20.955			
205KPP2	3	0.8760	2.0472	0.5910	1.0000			
		22.250	52.000	15.000	25.400			
205KRR2	1	0.8760	2.0472	0.5910	1.0000	HPC014GP	14KB205N	1 AH05-7/8
		22.250	52.000	15.000	25.400			
205KPPB2	4	0.8760	2.0472	0.5910	1.0000			
		22.250	52.000	15.000	25.400			
205KRRB2	2	0.8760	2.0472	0.5910	1.0000	HPS014GP	14K205N	2AH05-7'8
		22.250	52.000	15.000	25.400			
206KRR6	1	1.0010	2.4409	0.6300	0.9450	HPC100GP	16KB208N	1AH06-1
		25.425	62.000	16.000	24.000			
206KRRB6	2	1.0010	2.4409	0.6300	0.9450	HPS100GP	16K206N	2AH06-1
		25.425	62000	16.000	24.000			
G207KPPB2*	4	1.1260	2.8346	0.7480	1.4840	HPS102TR		
		28.600	72.000	19.000	37.694			
207KRRB9	2	1.1260	2.8346	0.6690	1.4840	HPS102GP	18K207N	2AH07-1 1/8
		28.600	72.000	17.000	37.694			
207KRRB12	2	1.1260	2.8346	0.6690	0.9840	HPS102GPF		
		28.600	72.000	17.000	25.000			
GW208PPB22*	4	1.2510	3.1496	0.8270	1.4380			
		31.877	80.000	21.000	36.520			
W208KRRB6	2	1.3760	3.1496	0.8270	1.4380	HPS106GPN		
		34.950	80.000	21.000	1.4380			
W208PPB16	4	1.2510	3.1496	0.7090	1.4380	HPS104TP	20K5-208E3	A2AH08-1 1/4V2
		31.775	80.000	18.000	36.520			
W208PP21	3	1.2510	3.1496	0.7090	1.4380			
		31.775	80000	18.000	36.520			

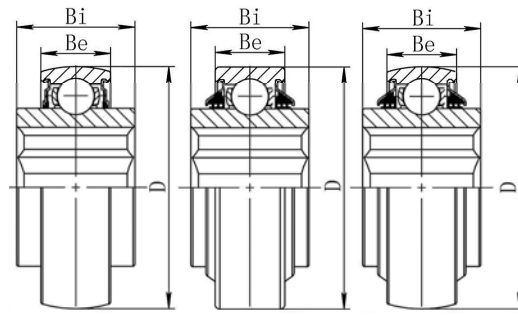

TYPE 1



TYPE 2

TYPE 3

TYPE 4

Designation <i>Sigla</i>	Type <i>Tipo</i>	Dimensions - <i>Dimensioni</i>				Bearings interchange <i>Intercambiabilità cuscinetti</i>		
		d	D	Be	Bi			
		[inch]				BCA	LINK-BELT	NTN
G209KPPB2*	4	1.5010	3.3465	0.7480	1.1810			
		38.125	85.000	19.000	30.000			
G5209KYYB2**		1.5010	3.3465	1.1811	1.2992			
		38.125	85.000	30.000	33.000			
209KRRB2	2	15.010	33.465	0.7480	11.810	HPS108GPH	24K209N	2AH09-1 1/2
		38.125	85.000	19.000	30.000			
210PPB20	3	1.2550	3.5433	0.8661	1.4350			
		31.877	90.000	22.000	36.450			
210PP20	3	1.2550	3.5433	0.8661	1.435			
		31.877	90.000	22.000	36.450			
G210KPPB2*	4	1.5010	3.5433	0.8661	1.1811			
		38.125	90.000	22.000	30.000			
GC211-32-NLC*	3	1.7510	3.9370	0.9840	2.2500			
		44,175	100.000	25.000	57.150			

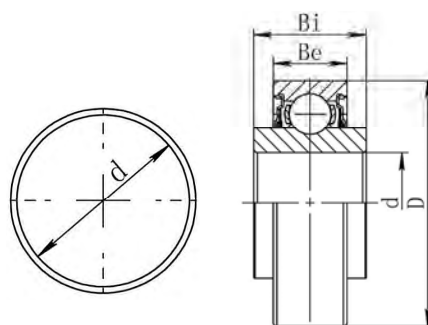
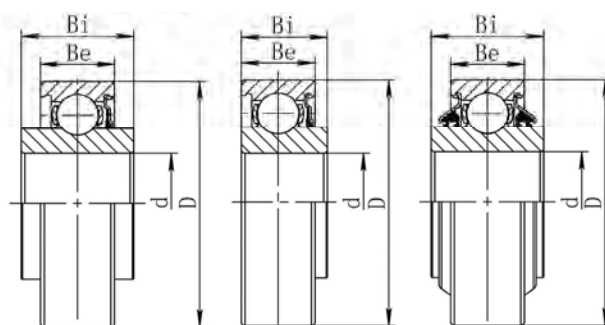
TYPE 1

TYPE 2
TYPE 3
TYPE 4

Designation <i>Sigla</i>	Type <i>Tipo</i>	Dimensions - <i>Dimensioni</i>				Bearings interchange <i>Intercambiabilità cuscinetti</i>		
		d	D	Be	Bi			
		[inch]				BCA	LINK-BELT	NTN
203KR2	3	0.6253 15.883	1.5748 40.000	0.5510 14.000	0.4724 12.000			
BB203KRR2*	1	0.6400 16.260	1.5748 40.000	0.7200 18.288	0.4724 12.000	203RRAR10N2		
203KRR2	1	0.6400 16.260	15.748 40.000	0.7200 18.288	0.4724 12.000	203RRAR10	123115	
BB203KRRFD**	4	0.6400 16.260	1.5748 40.000	0.7200 18.288	0.4724 12.000			
203KRR5	1	0.5150 13.081	1.5748 40.000	0.7200 18.288	0.4724 12.000	203RRAR8		
203KRR7	1	0.6693 17.000	1.5748 40.000	0.6540 16.612	0.4724 12.000			
207KPP	1	1.3780 35.000	2.8346 72.000	0.9840 25.000	0.6690 17.000			
208KRR2	1	1.5748 40.000	3.1496 80.000	1.0630 27.000	0.8270 21.000			

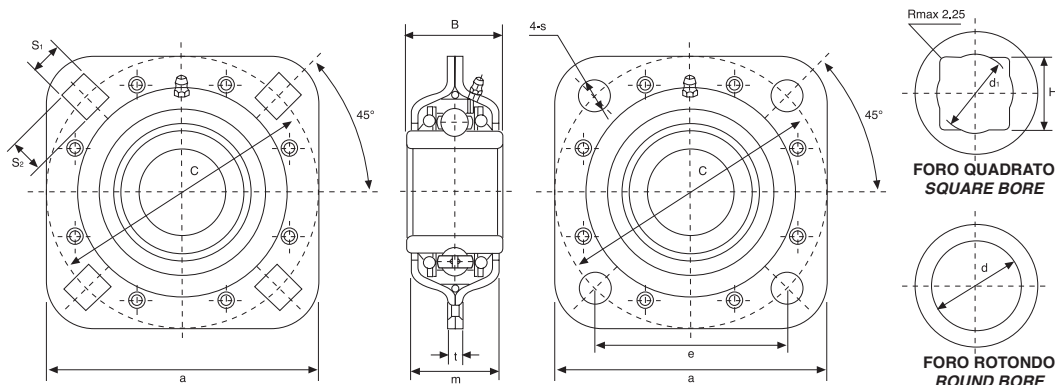
Normal duty - ST Serie normale



Type Tipo	Dimensions - Dimensioni												Load ratings (N) Coefficienti di carico (N)	
	H	d	a	B	m	t	C	s	s ₁	s ₂	d ₁	e	Dynamic C Dinamico C	Static C ₀ Statico C ₀
	[inch/mm]													
ST209-1½	29,972	-	127	42,8	42	6	127	13,5	13,5	17,45	32,0	-	24360	17710
ST209-30S	31,353	-	127	42,8	42	6	127	13,5	13,5	17,45	34,5	-	24360	17710
ST209-1¼	32,766	-	127	42,8	42	6	127	13,5	13,5	17,45	34,5	-	24360	17710
ST491B	-	38,860	127	42,8	42	6	127	13,5	13,5	17,45	-	-	24360	17710
ST209-40R	-	40,878	127	42,8	42	6	127	13,5	13,5	17,45	-	-	24360	17710
ST491A	-	45,000	127	42,8	42	6	127	13,5	13,5	17,45	-	90	24360	17710
ST209-45R	-	45,340	127	42,8	42	6	127	13,5	13,5	17,45	-	-	24360	17710
ST491A ¹⁾	-	45,000	121	46	42	6	121	13,5	-	-	-	85	24360	17710
ST211-1½	38,890	-	139,7	50,8	46	8	139,7	13,5	13,5	17,45	42,0	-	33370	25110
ST211-40S	40,878	-	139,7	50,8	46	8	139,7	13,5	13,5	17,45	43,1	-	33370	25110
ST211-50R	-	50,400	139,7	50,8	46	8	139,7	13,5	13,5	17,45	-	-	33370	25110
ST211-55R	-	55,575	139,7	50,8	46	8	139,7	13,5	13,5	17,45	-	-	33370	25110
ST211-1¾	-	45,212	139,7	55,6	46	8	139,7	13,5	13,5	17,45	-	-	33370	25110
ST211-2¾	-	55,575	139,7	55,6	46	8	139,7	13,5	13,5	17,45	-	-	33370	25110
ST211-1½½	-	49,238	139,7	69,9	46	8	139,7	13,5	13,5	17,45	-	-	33370	25110
ST211	-	55,000	139,7	55,6	46	8	139,7	13,5	13,5	17,45	-	-	33370	25110
ST740	-	55,562	139,7	55,6	45	7	139,7	13,5	13,5	17,45	-	98	33370	25110

¹⁾ Special dimensions - Dimensioni speciali

Available on request with square fixing holes - Disponibile su richiesta con fori di fissaggio quadrati

ISB	PEER	FAFNIR	BCA	LINK-BELT	NTN
W208PPB2	W208PPB2	W208PPB2		24R6-208E3	2AC08-1 1/2
W208PP5	W208PP5	W208PP5	DC208TT5	18S85-2E08E3	5AS08-1 1/8
W208PPB5	W208PPB5	W208PPB5	DS208TT5	18S5-2E08E3	1AS08-1 1/8
W208PP6	W208PP6	W208PP6	DC208TT6	16S85-208E3	
W208PPB6	W208PPB6	W208PPB6	DS208TT6	16S5-208E3	1AS08-1
W208PPB7	W208PPB7	W208PPB7	DS208TT7	19R208E3	1AC08-1 3/16
W208PP8	W208PP8	W208PP8	DC208TT8	18S82-2E08E3	6AS09-1 1/8
W208PPB8	W208PPB8	W208PPB8	DS208TT8	18S2-2E08E3	2AS08-1 1/8
W208PPB9	W208PPB9	W208PPB9	OS208TT9	16S2-208E3	2AS08-1 1/8
W208PP10	W208PP10	W208PP10	DC208TT10	24RB8-208E3	
W208PPB10	W208PPB10	W208PPB10			
W208PPB11	W208PPB11	W208PPB11	DS208TT11	14S4-208E3	4AS08-7/8
W208PPB12	W208PPB12	W208PPB12	DS208TT12	18S4-2E08E3	4AS08-1 1/8
W208PPB13	W208PPB13	W208PPB13	DS208TT13	14S 5-208E3	1AS08-7/8
W208PPB23	W208PPB23	W208PPB23	DS208TT2A		
GW208PPB5	GW208PPB5	GW208PPB5	DS208TTR21	18SG7-2E08E3	1AS08-1 5/3201
GW208PPB6	GW208PPB6	GW208PPB6	DS208TTR6	16SG7-208E3	
GW208PPB8	GW208PPB8	GW208PPB8	DS208TTR8	18SG2-2E08E3	2AS08-1 1/8 D1
GW208PP17	GW208PP17	GW208PP17	DC208TTR17		
GW208PPB17	GW208PPB17	GW208PPB17			
W209PPB2	W209PPB2	W209PPB2	DS209TT2	R3-209E3	
W209PPB4	W209PPB4	W209PPB4	DS209TT4	24R3-209E3	3AC09-1/2
W209PPB5	W209PPB5	W209PPB5	DS209TT5	20S2-209E3	2AS09-1 1/4
W209PPB6	W209PPB6	W209PPB6	DS209TT6	24R-209E3	
W209PPB7	W209PPB7	W209PPB7	DS209TT7	20S4-209E3	
W209PPB8	W209PPB8	W209PPB8	DS209TT8A		
GW209PPB2	GW209PPB2	GW209PPB2	DS209TTR2	RG3-209E3	3AC09D1
GW209PPB4	GW209PPB4	GW209PPB4	DS209TTR4	24RG3-209E3	3AC091 1/2 D1
GW209PPB5	GW209PPB5	GW209PPB5	DS209TTR5		
GW209PPB8	GW209PPB8	GW209PPB8	DS209TTR8	20SG5-209E3	
GW209PPB11	GW209PPB11	GW209PPB11	DS209TTR10		1AC09D1V1
W210PP2	W210PP2	W210PP2	DC210TT2	31RB3-210E3	7AC10-1 15/16
W210PPB2	W210PPB2	W210PPB2	DS210TT2	31R3-210E3	3AC10-1 15/16
W210PP4	W210PP4	W210PP4	DC210TT4	18SB3-210E3	7AS10-1 1/8
W210PPB4	W210PPB4	W210PPB4	DS210TT4	18S3-210E3	3AS10-1 3/4
W210PPB5	W210PPB5	W210PPB5	DS210TT5	28R3-210E3	3AC10-1 3/4
W210PPB6	W210PPB6	W210PPB6	OS210TT6	18S2-210E3	2AS10-1 1/8
W210PPB9	W210PPB9	W210PPB9			
GW210PPB2	GW210PPB2	GW210PPB2	DS210TTR2	31RG3-210E3	3AC10-1 15/16 D1
GW210PP4	GW210PP4	GW210PP4	DC210TTR4	18SBG3-210E3	7AS10-1 1/8 D1
GW210PPB4	GW210PPB4	GW210PPB4	DS210TTR4	18SG3-210E3	
GW210PPB5	GW210PPB5	GW210PPB5	DS210TTR5R	28RG3-210E3	3AC10-1 3/4 D1
W211PP2	W211PP2	W211PP2	DC211TT2	35RB3-211E3	7AC11-2 3/16
W211PPB2	W211PPB2	W211PPB2	DS211TT2	35R3-211E3	3AC11-2 3/16
W211PP3	W211PP3	W211PP3	DC211TT3	24SB3-211E3	7AS11-1 1/2
W211PPB3	W211PPB3	W211PPB3	DS211TT3	24S3-211E3	3AS11-1 1/2
W211PPB4	W211PPB4	W211PPB4	DS211TT4		
W211PP5	W211PP5	W211PP5	DC211TT5		6AS11-1 1/2 VI
W211PPB5	W211PPB5	W211PPB5			
W211PPB6	W211PPB6	W211PPB6	DS211TT6		4AS11-1 1/2

ISB	PEER	FAFNIR	BCA	LINK-BELT	NTN
GW211PP2	GW211PP2	GW211PP2	DC211TTR2	35RBG3-211E3	7AS11-1 1/2 D1
GW211PPB2	GW211PPB2	GW211PPB2	DS211TTR2	35RG3-211E3	3AC11-2 3/16 D1
GW211PP3	GW211PP3	GW211PP3	DC211TTR3	24SBG3-211E3	7AS11-1 1/2 D1
GW211PPB3	GW211PPB3	GW211PPB3	DS211TTR3	24SG3-211E3	3AS11-1 1/2 D1
GW211PP5	GW211PP5	GW211PP5			
GW211PPB9	GW211PPB9	GW211PPB9	DS211TTR9		
GW211PPB13	GW211PPB13	GW211PPB13	DS211TTR13		
GW211PP17	GW211PP17	GW211PP17	DC211TTR3E		
GW211PPB17	GW211PPB17	GW211PPB17			
GW211PP25	GW211PP25	GW211PP37	DC211TTR21		
GW214PP2	GW214PP2	GW214PP2	DC214TTR2		
GW214PPB2	GW214PPB2	GW214PPB2			3AC14D1
GW214PPB3	GW214PPB3		DS214TTR3		
GW214PPB4	GW214PPB4	GW214PPB4			3AS14-2DI
GW214PPB5	GW214PPB5	GW1214PPB5	DS214TTR5		
GW214PPB6	GW214PPB6		DS214TTRA		
GW216PP2	GW216PP2	GW216PP2	DC216TTR2		
RX84	RX84				
X365	X365				
202KRR3	202KRR3	202KRR3			
202NPP9	202NPP9	202NPP9	202FFH8		
202RRE	202RRE	J202KRR8	202KRR8		
CF5202-2RST-8	CF5202-2RST-8				DF0109LLPK1
203JD	203JD		203K		5X0366LUL
203KR2	203KR2	203KR2			
BB203KRR2	BB203KRR2	BB203KRR2	203RRAR10N2		
BB203KRR2FD	BB203KRR2FD				
203KRR2	203KRR2	203KRR2	203RRAR10	126115	
203KRR2FD	203KRR2FD				
203KRR3	203KRR3	203KRR3	8984YY	BS226119	
203KRR5	203KRR5	203KRR5	203RRAR8		
203KRR6	203KRR6	203KRR6	203RRH10		
203NPP9	203NPP9	2Q3NPP9			
5203KYY2	5203KYY2	5203KYY2			
Z9504-2RST	Z9504-2RST	P204RR6	204BBAR		SC0451IIC3
204KRR2	204KRR2	204KRR2	HPC01IGP	11KB204N	1AH04-11/16
204KRRB2	204KRRB2	204KRRB2		11K204N	
204KRR14	204KRR14	204KRR14			
204JY3	204JY3	204RY2	204FVMN		
204KRD4	204KRD4	204KRD4	204FGB		
204RR8	204RR8	204RR8	204BBE		
205KRP2	205KRP2	205KRP2	205RVA		
205KR3	205KR3	205KR3	205RHN		
205KP6	205KP6	205KP6	205TNJ		
205KP8	205KP8	205KP8	205-TNK		
205KPP2	205KPP2				
205KPPB2	205KPPB2				
205KRR2	205KRR2	205KRR2	HPC014GP	14KB205N	1AH05-7/8
205KRRB2	205KRRB2	205KRRB2	HPS014GP	14K205N	2AH05-7/8
205KRR7	205KRR7	205KRR7	205RRUN		
205KYY3	205KYY3	205KYY3	205-VVA		
G205PPB7	G205PPB7		205TTRH		
205PPB7	205PPB7	205PPB7	205TTH	BS217948N	

ISB	PEER	FAFNIR	BCA	LINK-BELT	NTN
205PP8	205PP8	205PP8			
205PP9	205PP9	205PP9	205TTB	BS225817	
205PP10	205PP10	205PP10			
205PP12	205PP12	205PP12	205TTP		
6205-2RST-22	6205-2RST-22	205PPB	S205FF		CS205LLU
206K14	206K14	206K14			
206KP2	206KP2	206KP2			
206KPP16	206KPP16	206KPP16	206GGH		
206KRR6	206KRR6	206KRR6	HPC100GP	16KB206N	1AH06-1
206KRRB6	206KRRB6	206KRRB6	HPS100GP	16K206N	2AH06-1
206KRP4	206KRP4	206KPR4			
206KPPB5	206KPPB5	206KPPB5			
5206KPP3	5206KPP3	5206KPP3			
G207KPPB2	G207KPPB2	G207KPPB2	HPS102TR		
207KRR14	207KRR14	207KRR14			
207KRRB9	207KRRB9	207KRRB9	HPS102GP	18K207N	2AH07-1 1/8
207KRRB12	207KRRB12	207KRRB12	HPS102GPE		
207KYY	207KYY	207 KYY			
88107	88107	207KRR3	88107		
GW208PPB22	GW208PPB22	GVV208PPB22			
W208K2	W208K2	W208K2			DC208-TT2
W208K3	W208K3	W208K3			DC208
W208KRRB6	W208KRRB6	W208KRRB6	HPS106GPN		
W208PPB16	W208PPB16	W208PPB16	HPS104TP	20K5-208E3	A2AH08-1 1/4V2
208KRR4	208KRR4	208KRR4			
G209KPPB2	G209KPPB2				
209KRRB2	209KRRB2	209KRRB2	HPS108GPH	24K209N	2AH09-1 1/^2
GW209PPB22-BR209RH	GW209PPB22-BR209RH		CDS209TTR6P		
G5209KYYB2	G5209KYYB2				
GC211-32-NLC	GC211-32-NLC	GC1200KPPB2			
GW211PPB21-BR211RH	GW211PPB21-BR211RH		CDS211TTR23		
W213-8445	W213-8445		8445		

Standard duty - SER2 Serie normale

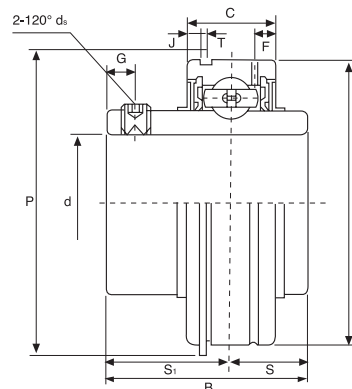

UNF suffix: inch sizes set screws

Suffisso UNF: Misure in pollici dei grani di bloccaggio

Type Tipo	Dimensions - Dimensioni												Load ratings (N) Coefficienti di carico (N)		Weight Peso
	d	D	B	C	S	S ₁	T	F	J	P	G	d _s	Dynamic C Dinamico C	Static C ₀ Statico C ₀	
	[inch/mm]														
SER204	20	47	31	15,9	10,3	20,7	1,12	3,8	2,46	52,7	4,8	M6x1	9880	6200	0,21
SER204-12	¾	1,8504	1,2205	0,6260	0,406	0,815	0,044	0,150	0,097	2,075	0,189	¼-28UNF			
SER205	25	52	34,9	19	13,1	21,8	1,12	5,2	2,46	57,9	5	M6x1	10780	6980	0,27
SER205-13	1⅜	2,0472	1,3740	0,7480	0,516	0,858	0,044	0,205	0,097	2,280	0,197	¼-28UNF			
SER205-14	7⁄8														
SER205-15	1⅝														
SER205-16	1														
SER206	30	62	38,1	22,2	15,9	22,2	1,7	5,6	3,28	67,7	5	M6x1	14970	10040	0,39
SER206-17	1⅞	2,4409	1,5000	0,8740	0,626	0,874	0,067	0,220	0,129	2,665	0,197	¼-28UNF			
SER206-18	1⅞														
SER206-19	1⅜														
SER206-20	1¼														
SER207	35	72	42,9	23,8	17,5	25,4	1,7	5,6	3,28	78,6	6,7	M8x1	19750	13670	0,63
SER207-20	1¼	2,8346	1,6890	0,9370	0,689	1,000	0,067	0,220	0,129	3,094	0,264	⅝-24UNF			
SER207-21	1⅝														
SER207-22	1⅜														
SER207-23	1⅞														
SER208	40	80	49,2	27,8	19	30,2	1,7	6,4	3,28	86,6	8	M8x1	22710	14940	0,81
SER208-24	1½	3,1496	1,9370	1,0945	0,748	1,189	0,067	0,252	0,129	3,409	0,315	⅝-24UNF			
SER208-25	1⅝														
SER209	45	85	49,2	27,8	19	30,2	1,7	6,4	3,28	91,6	8	M8x1	24360	17710	0,90
SER209-26	1⅞	3,3465	1,9370	1,0945	0,748	1,189	0,067	0,252	0,129	3,606	0,315	⅝-24UNF			
SER209-27	1⅞														
SER209-28	1¾														
SER210	50	90	51,6	28,6	19	32,6	2,46	7,5	3,28	96,5	10	M10x1	26980	19840	0,98
SER210-29	1⅜	3,5433	2,0315	1,1260	0,748	1,283	0,097	0,295	0,129	3,799	0,394	¾-24UNF			
SER210-30	1⅞														
SER210-31	1⅝														
SER210-32	2														
SER211	55	100	55,6	30,2	22,2	33,4	2,46	7,5	3,28	106,5	10	M10x1	33370	25110	1,40
SER211-32	2	3,9370	2,1890	1,1890	0,874	1,315	0,097	0,295	0,129	4,193	0,394	¾-24UNF			
SER211-33	2⅞														
SER211-34	2⅞														
SER211-35	2⅜														
SER212	60	110	65,1	31,8	25,4	39,7	2,46	7,5	3,28	116,6	10	M10x1	36740	27970	1,89
SER212-36	2¼	4,3307	2,5630	1,2520	1,000	1,563	0,097	0,295	0,129	4,591	0,394	¾-24UNF			
SER212-37	2⅝														
SER212-38	2⅝														
SER212-39	2⅞														



SEALED BALL BEARINGS WITH SET SCREWS - CUSCINETTI A SFERE SIGILLATI CON GRANI DI BLOCCAGGIO

Standard duty - UC2 Serie normale

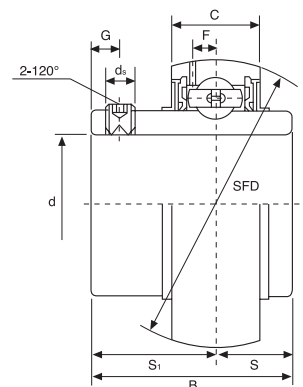

UNF suffix: inch sizes set screws

Suffisso UNF: Misure in pollici dei grani di bloccaggio

Type Tipo	Dimensions - Dimensioni									Load ratings (N) Coefficienti di carico (N)		Weight Peso
	d	D	B	C	S	S ₁	G	d _s	F	Dynamic C Dinamico C	Static C ₀ Statico C ₀	
	[inch/mm]											kg
UC201	12	47	31	17	12,7	18,3	4,8	M6x1	3,7	12160	6318	0,20
UC201-8	¾	1,8504	1,2205	0,6693	0,500	0,720	0,189	¼-28UNF	0,146			0,19
UC202	15	47	31	17	12,7	18,3	4,8	M6x1	3,7	12160	6318	0,19
UC202-9	⅝	1,8504	1,2205	0,6693	0,500	0,720	0,189	¼-28UNF	0,146			0,19
UC202-10	⅝											0,19
UC203	17	47	31	17	12,7	18,3	4,8	M6x1	3,7	12160	6318	0,18
UC203-11	1⅛	1,8504	1,2205	0,6693	0,500	0,720	0,189	¼-28UNF	0,146			0,17
*UC204	20	47	31	17	12,7	18,3	4,8	M6x1	3,7	12160	6318	0,16
UC204-12	¾	1,8504	1,2205	0,6693	0,500	0,720	0,189	¼-28UNF	0,146			0,16
*UC205	25	52	34,1	17	14,3	19,8	5	M6x1	3,9	13300	7457	0,20
UC205-13	1⅜											0,24
UC205-14	⅞											0,23
UC205-15	1⅝	2,0472	1,3425	0,6693	0,563	0,780	0,197	¼-28UNF	0,154			0,21
UC205-16	1											0,20
*UC206	30	62	38,1	19	15,9	22,2	5	M6x1	5,0	18525	10735	0,32
UC206-17	1⅜											0,33
UC206-18	1⅝	2,4409	1,5000	0,7480	0,626	0,874	0,197	¼-28UNF	0,197			0,34
UC206-19	1⅜											0,32
UC206-20	1¼											0,31
*UC207	35	72	42,9	20	17,5	25,4	7	M8x1	5,7	24415	14630	0,48
UC207-20	1¼											0,54
UC207-21	1⅝	2,8346	1,6890	0,7874	0,689	1,000	0,276	⅝-24UNF	0,224			0,51
UC207-22	1⅝											0,48
UC207-23	1⅞											0,45
*UC208	40	80	49,2	21	19	30,2	8	M8x1	6,2	27645	16910	0,64
UC208-24	1½	3,1496	1,9370	0,8268	0,748	1,189	0,315	⅝-24UNF	0,244			0,68
UC208-25	1⅝											0,65
*UC209	45	85	49,2	22	19	30,2	8	M8x1	6,4	32395	20235	0,68
UC209-26	1⅝											0,78
UC209-27	1⅝	3,3465	1,9370	0,8661	0,748	1,189	0,315	⅝-24UNF	0,252			0,74
UC209-28	1¾											0,70
*UC210	50	90	51,6	24	19	32,6	10	M10x1	6,5	33345	22135	0,80
UC210-29	1⅜											0,92
UC210-30	1⅞	3,5433	2,0315	0,9449	0,748	1,283	0,394	⅝-24UNF	0,256			0,87
UC210-31	1⅝											0,82
UC210-32	2											0,78
*UC211	55	100	55,6	25	22,2	33,4	10	M10x1	7,0	41230	27930	1,11
UC211-32	2											1,26
UC211-33	2¼	3,9370	2,1890	0,9843	0,874	1,315	0,394	⅝-24UNF	0,276			1,20
UC211-34	2⅝											1,15
UC211-35	2⅜											1,09
*UC212	60	110	65,1	27	25,4	39,7	10	M10x1	7,6	49780	34390	1,54
UC212-36	2¼											1,67
UC212-37	2⅝	4,3307	2,5630	1,0630	1,000	1,563	0,394	⅝-24UNF	0,299			1,59
UC212-38	2⅝											1,52
UC212-39	2⅞											1,45
UC213	65	120	65,1	28	25,4	39,7	10	M10x1	8,5	54340	38095	1,85
UC213-40	2½	4,7244	2,5630	1,1024	1,000	1,563	0,394	⅝-24UNF	0,335			1,94
UC213-41	2⅝											1,85
UC214	70	125	74,6	29	30,2	44,4	12	M12x1,5	8,9	59090	41895	2,05
UC214-42	2⅝											2,26
UC214-43	2⅞	4,9213	2,9370	1,1417	1,189	1,748	0,472	⅞-20UNF	0,350			2,16
UC214-44	2¾											2,06
UC215	75	130	77,8	30	33,3	44,5	12	M12x1,5	9,2	64030	45885	2,21
UC215-45	2⅜											2,46
UC215-46	2⅞	5,1181	3,0630	1,1811	1,311	1,752	0,472	⅞-20UNF	0,362			2,35
UC215-47	2⅝											2,24
UC215-48	3											2,12
UC216	80	140	82,6	32	33,3	49,3	12	M12x1,5	9,5	69065	50350	2,80
UC216-49	3⅝											2,98
UC216-50	3⅝	5,5118	3,2520	1,2598	1,311	1,9409	0,472	⅞-20UNF	0,374			2,85
UC216-51	3⅝											2,72
UC217	85	150	85,7	34	34,1	51,6	12	M12x1,5	10,2	79800	58805	3,46
UC217-52	3¼											3,68
UC217-53	3⅝	5,9055	3,3740	1,3386	1,343	2,031	0,472	⅞-20UNF	0,402			3,54
UC217-55	3⅞											3,25
UC218	90	160	96	36	39,7	56,3	12	M12x1,5	11,2	91295	67925	4,36
UC218-56	3½	6,2992	3,7795	1,4173	1,5630	2,217	0,472	⅞-20UNF	0,441			4,47

Available stainless steel AISI 440C or 420C - Disponibile in acciaio inox AISI 440C o 420C

* Equipped with anti-rust shield star shape, screw with ball and burnished inner ring - Fornito con schermo antipolvere a stella, grano con sfera e anello interno brunito

Light duty - SB-RB2 Serie leggera

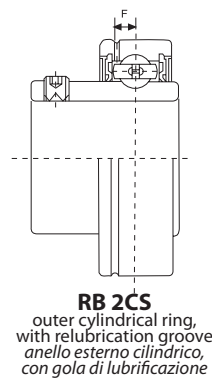
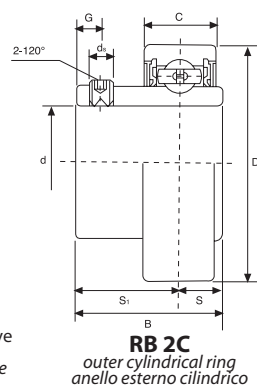
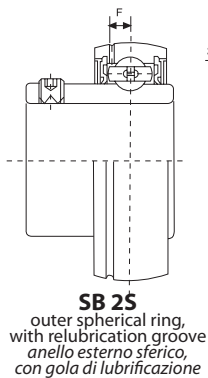
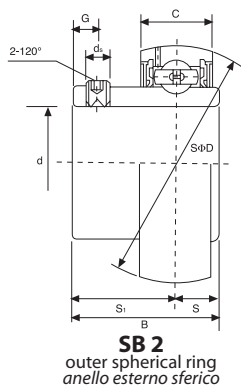

UNF suffix: inch sizes set screws

Suffisso UNF: Misure in pollici dei grani di bloccaggio

Type Tipo	Dimensions - Dimensioni									Load ratings (N) Coefficienti di carico (N)		Weight Peso
	d	D	B	C	S	S ₁	d _s	G	F	Dynamic C Dinamico C	Static C ₀ Statico C ₀	
	[inch/mm]											kg
SB-RB201	12	40	22	12	6	16	M5x0,8	4,5	3,7	9200	4480	0,10
SB-RB201-8	¾	1,5748	0,8661	0,4724	0,236	0,630	10-32UNF	0,177	0,146			0,10
SB-RB202	15	40	22	12	6	16	M5x0,8	4,5	3,7	9200	4480	0,10
SB-RB202-9	⅝	1,5748	0,8661	0,4724	0,236	0,630	10-32UNF	0,177	0,146			0,10
SB-RB202-10	⅝											0,10
SB-RB203	17	40	22	12	6	16	M5x0,8	4,5	3,7	9200	4480	0,09
SB-RB203-11	1⅞	1,5748	0,7520	0,4724	0,256	1/4-28UNF	0,189	0,531	0,146			0,09
SB-RB204	20	47	25	14	7	18	M6x1	4,5	3,7	12200	6300	0,13
SB-RB204-12	¾	1,8504	0,9843	0,5512	0,276	0,709	¼-28UNF	0,177	0,146			0,14
SB-RB205	25	52	27	15	7,5	19,5	M6x1	5,5	3,9	13300	7460	0,16
SB-RB205-13	1⅜	2,0472	1,0630	0,5906	0,295	0,768	¼-28UNF	0,217	0,154			0,19
SB-RB205-14	7/8											0,18
SB-RB205-15	1⅝											0,17
SB-RB205-16	1											0,16
SB-RB206	30	62	30	16	8	22	M6x1	6	5,0	18500	10800	0,25
SB-RB206-17	1⅞	2,4409	1,1811	0,6299	0,315	0,866	¼-28UNF	0,236	0,197			0,28
SB-RB206-18	1⅞											0,26
SB-RB206-19	1⅜											0,25
SB-RB206-20	1¼											0,24
SB-RB207	35	72	32	17	8,5	23,5	M8x1	6,5	5,7	24500	14600	0,38
SB-RB207-20	1¼	2,8346	1,2598	0,6693	0,335	0,925	⅝-24UNF	0,256	0,224			0,43
SB-RB207-21	1⅝											0,41
SB-RB207-22	1⅜											0,38
SB-RB207-23	1⅞											0,37
SB-RB208	40	80	34	18	9	25	M8x1	7	6,2	27700	17000	0,60
SB-RB208-24	1½	3,1496	1,3386	0,7087	0,354	0,984	⅝-24UNF	0,276	0,244			0,58
SB-RB208-25	1⅞											0,60
SB-RB209	45	85	41,2	19	10,2	31	M8x1	8,2	6,4	31100	24450	0,8
SB-RB209-26	1⅝	3,3465	1,6220	0,7480	0,402	1,220	⅝-24UNF	0,323	0,252			
SB-RB209-27	1⅞											
SB-RB209-28	1¾											
SB-RB210	50	90	43,5	20	10,9	32,6	M10x1	9,2	6,5	35300	28160	0,8
SB-RB210-29	1⅜	3,5433	1,7126	0,7874	0,429	1,283	⅝-24UNF	0,362	0,256			
SB-RB210-30	1⅞											
SB-RB210-31	1⅝											
SB-RB210-32	2											
SB-RB211	55	100	45,3	21	11,8	33,5	M10x1	9,8	7,0	38100	30000	1,1
SB-RB211-32	2	3,9370	1,7835	0,8268	0,465	1,319	⅝-24UNF	0,386	0,276			
SB-RB211-33	2⅞											
SB-RB211-34	2⅞											
SB-RB211-35	2⅜											
SB-RB212	60	110	53,7	22	14,9	38,8	M10x1	9,8	7,6	41500	32730	1,3
SB-RB212-36	2¼	4,3307	2,1142	0,8661	0,587	1,528	⅝-24UNF	0,386	0,299			
SB-RB212-37	2⅝											
SB-RB212-38	2⅜											
SB-RB212-39	2⅞											

Available stainless steel AISI 440C or 420C - Disponibile in acciaio inox AISI 440C o 420C

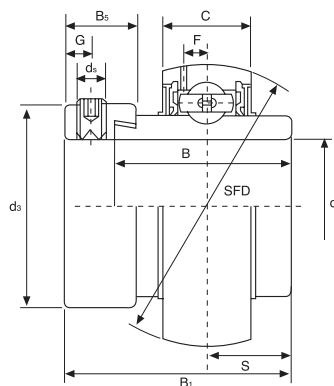
Standard duty - UC2 Serie normale

UNF suffix: inch sizes set screws

Suffisso UNF: Misure in pollici dei grani di bloccaggio

Type Tipo	Dimensions - Dimensioni											Load ratings (N) Coefficienti di carico (N)		Weight Peso
	d	D	B _t	B	C	S	d _s	G	B _s	d _s	F	Dynamic C Dinamico C	Static C ₀ Statico C ₀	
	[inch/mm]													kg
HC204	20	47	43,7	34,2	17	17,1	M6x1	4,8	13,5	33,3	3,7	12160	6318	0,23
HC204-12	¾	1,8504	1,720	1,3465	0,6693	0,673	¼-28UNF	0,189	0,531	1,311	0,146			0,23
HC205	25	52	44,4	34,9	17	17,5	M6x1	4,8	13,5	38,1	3,9	13300	7457	0,27
HC205-13	1⅜	2,0472	1,748	1,3740	0,6693	0,689	¼-28UNF	0,189	0,531	1,500	0,154			0,32
HC205-14	7⁄8													0,31
HC205-15	15⁄16													0,29
HC205-16	1													0,27
HC206	30	62	48,4	36,5	19	18,3	M8x1	6	15,9	44,5	5,0	18525	10735	0,45
HC206-17	1⅞	2,4409	1,906	1,4370	0,7480	0,720	⅝-24UNF	0,236	0,626	1,752	0,197			0,50
HC206-18	1⅞													0,47
HC206-19	1⅞													0,45
HC206-20	1¼													0,42
HC207	35	72	51,1	37,6	20	18,8	M8x1	6,8	17,5	55,6	5,7	24415	14630	0,60
HC207-20	1¼	2,8346	2,012	1,4803	0,7874	0,740	⅝-24UNF	0,268	0,689	2,189	0,224			0,67
HC207-21	1⅞													0,63
HC207-22	1⅞													0,60
HC207-23	1⅞													0,57
HC208	40	80	56,3	42,8	21	21,4	M8x1	6,8	18,3	60,3	6,2	27645	16910	0,79
HC208-24	1½	3,1496	2,217	1,6850	0,8268	0,843	⅝-24UNF	0,268	0,720	2,374	0,244			0,84
HC208-25	1⅞													0,80
HC209	45	85	56,3	42,8	22	21,4	M8x1	6,8	18,3	63,5	6,4	32395	20235	0,85
HC209-26	1⅞	3,3465	2,217	1,6850	0,8661	0,843	⅝-24UNF	0,268	0,720	2,5000	0,252			0,96
HC209-27	1⅞													0,91
HC209-28	1¾													0,87
HC210	50	90	62,7	49,2	24	24,6	M8x1	6,8	18,3	69,9	6,5	33345	22135	0,99
HC210-29	1⅞	3,5433	2,469	1,9370	0,9449	0,969	⅝-24UNF	0,268	0,720	2,752	0,256			1,14
HC210-30	1⅞													1,08
HC210-31	1⅞													1,02
HC210-32	2													0,96
HC211	55	100	71,4	55,5	25	27,8	M10x1	8	20,7	76,2	7,0	41230	27930	1,32
HC211-32	2	3,9370	2,811	2,1850	0,9843	1,094	¾-24UNF	0,315	0,815	3,000	0,276			1,52
HC211-33	2⅞													1,44
HC211-34	2⅞													1,37
HC211-35	2⅞													1,29
HC212	60	110	77,8	61,9	27	31	M10x1	8	22,3	84,2	7,6	49780	34390	1,88
HC212-36	2¼	4,3307	3,063	2,4370	1,0630	1,220	¾-24UNF	0,315	0,878	3,315	0,299			2,04
HC212-37	2⅞													1,95
HC212-38	2⅞													1,90
HC212-39	2⅞													1,77
HC213	65	120	85,7	68,6	28	34,1	M10x1	8,5	23,5	86	8,5	54340	38095	2,41
HC213-40	2½	4,7244	3,374	2,7008	1,1024	1,343	¾-24UNF	0,335	0,925	3,386	0,335			2,51
HC213-41	2⅞													2,40
HC214	70	125	85,7	68,6	29	34,1	M10x1	8,5	23,5	90	8,9	59090	41895	2,55
HC214-42	2⅞	4,9213	3,374	2,7008	1,1417	1,343	¾-24UNF	0,335	0,925	3,543	0,350			2,79
HC214-43	2⅞													2,68
HC214-44	2¾													2,56
HC215	75	130	92,1	75	30	37,3	M10x1	8,5	23,5	102	9,2	64030	45885	2,84
HC215-45	2⅞	5,1181	3,626	2,9528	1,1811	1,469	¾-24UNF	0,335	0,925	4,016	0,362			3,14
HC215-46	2⅞													3,01
HC215-47	2⅞													2,88
HC215-48	3													2,74

Available stainless steel AISI 440C or 420C - Disponibile in acciaio inox AISI 440C o 420C

Light duty - SA2 Serie leggera

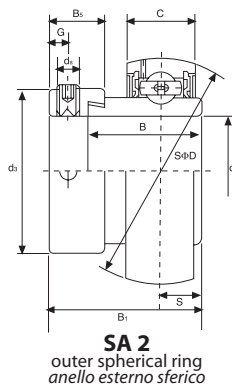

SA 2S
outer spherical ring,
with relubrication groove
anello esterno sferico,
con gola di lubrificazione

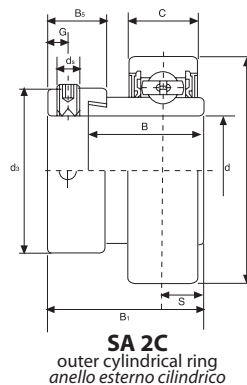

SA 2C
outer cylindrical ring,
with relubrication groove
anello esterno cilindrico,
con gola di lubrificazione

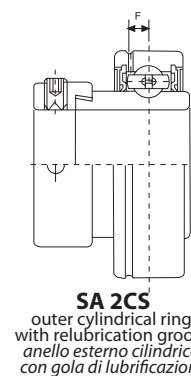

UNF suffix: inch sizes set screws

Suffisso UNF: Misure in pollici dei grani di bloccaggio

Type Tipo	Dimensions - Dimensioni											Load ratings (N) Coefficienti di carico (N)		Weight Peso
	d	D	B ₁	B	C	S	d _s	G	B _s	d ₃	F	Dynamic C Dinamico C	Static C ₀ Statico C ₀	
	[inch/mm]													kg
SA201	12	40	28,6	19,1	12	6,5	M6x1	4,8	13,5	28,6	3,7	9200	4480	0,12
SA201-8	¾	1,5748	1,126	0,7520	0,4724	0,256	¼-28UNF	0,189	0,531	1,126	0,146			0,12
SA202	15	40	28,6	19,1	12	6,5	M6x1	4,8	13,5	28,6	3,7	9200	4480	0,10
SA202-9	⅝	1,5748	1,126	0,7520	0,4724	0,256	¼-28UNF	0,189	0,531	1,126	0,146			0,10
SA202-10	⅝	1,5748	1,126	0,7520	0,4724	0,256	¼-28UNF	0,189	0,531	1,126	0,146	9200	4480	0,10
SA203	17	40	28,6	19,1	12	6,5	M6x1	4,8	13,5	28,6	3,7			0,09
SA203-11	⅞	1,5748	1,126	0,7520	0,4724	0,256	¼-28UNF	0,189	0,531	1,126	0,146	9200	4480	0,09
SA204	20	47	31	21,5	14	7,5	M6x1	4,8	13,5	33,3	3,7	12200	6300	0,16
SA204-12	¾	1,8504	1,220	0,8465	0,5512	0,295	¼-28UNF	0,189	0,531	1,311	0,146			0,16
SA205	25	52	31	21,5	15	7,5	M6x1	4,8	13,5	38,1	3,9	13300	7460	0,20
SA205-13	1⅜	2,0472	1,220	0,8465	0,5906	0,295	¼-28UNF	0,189	0,531	1,500	0,154			0,22
SA205-14	⅞													0,21
SA205-15	1⅝													0,21
SA205-16	1													0,20
SA206	30	62	35,7	23,8	16	9	M8x1	6	15,9	44,5	5,0	18500	10800	0,30
SA206-17	1⅞	2,4409	1,406	0,9370	0,6299	0,354	⅝-28UNF	0,236	0,626	1,752	0,197			0,32
SA206-18	1⅞													0,31
SA206-19	1⅜													0,30
SA206-20	1¼													0,29
SA207	35	72	38,9	25,4	17	9,5	M8x1	6,8	17,5	55,6	5,7	24500	14600	0,42
SA207-20	1¼	2,8346	1,531	1,000	0,6693	0,374	⅝-24UNF	0,268	0,689	2,189	0,224			0,46
SA207-21	1⅝													0,43
SA207-22	1⅜													0,42
SA207-23	1⅞													0,41
SA208	40	80	43,7	30,2	18	11	M8x1	6,8	18,3	60,3	6,2	27700	17000	0,60
SA208-24	1½	3,1496	1,721	1,1890	0,7087	0,433	⅝-24UNF	0,268	0,720	2,374	0,244			0,58
SA208-25	1⅞													0,60
SA209	45	85	43,7	30,2	19	11	M8x1	6,8	18,3	63,5	6,4	31100	24450	0,76
SA209-26	1⅝	3,3465	1,721	1,1890	0,7480	0,433	⅝-24UNF	0,268	0,720	2,500	0,252			
SA209-27	1⅞													
SA209-28	1¾													
SA210	50	90	43,7	30,2	20	11	M8x1	6,8	18,3	69,9	6,5	35300	28160	0,91
SA210-29	1⅜	3,5433	1,721	1,1890	0,7874	0,433	⅝-24UNF	0,268	0,720	2,752	0,256			
SA210-30	1⅞													
SA210-31	1⅝													
SA210-32	2	4,3307	2,091	1,4646	0,8661	0,532	⅝-24UNF	0,315	0,878	3,315	0,299	41500	32730	1,70
SA211	55													
SA211-32	2													
SA211-33	2⅞													
SA211-34	2⅞													
SA211-35	2⅜													
SA212	60	110	53,1	37,2	22	13,5	M10x1	8	22,3	84,2	7,6	41500	32730	1,70
SA212-36	2¼	4,3307	2,091	1,4646	0,8661	0,532	⅝-24UNF	0,315	0,878	3,315	0,299			
SA212-37	2⅝													
SA212-38	2⅝													
SA212-39	2⅞													

Available stainless steel AISI 440C or 420C - Disponibile in acciaio inox AISI 440C o 420C





INDUSTRIES
BEARINGS & COMPONENTS

SPECIAL BEARINGS
CUSCINETTI SPECIALI

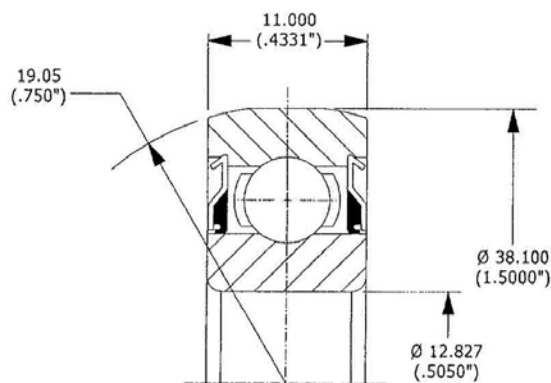
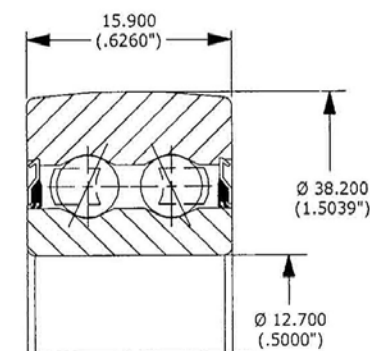
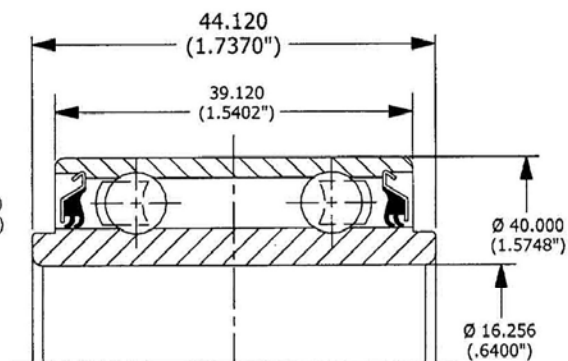
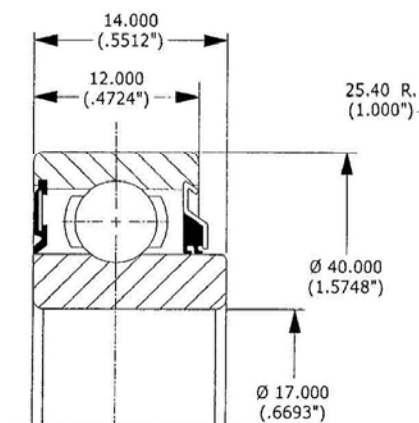
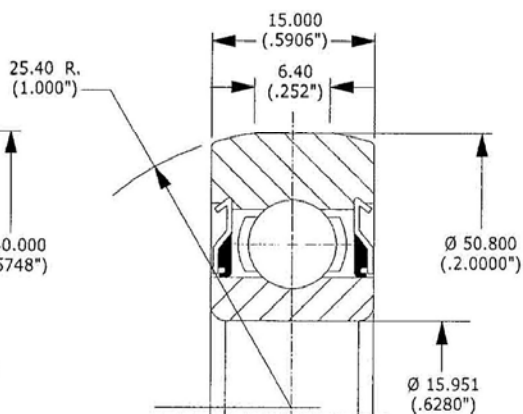
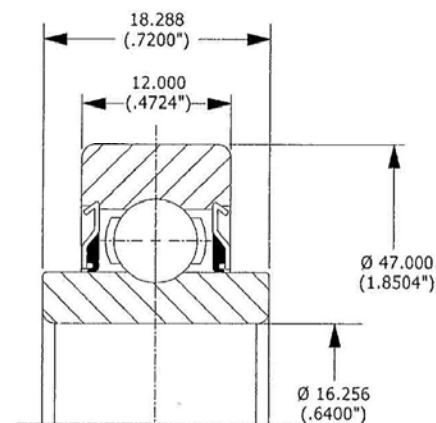
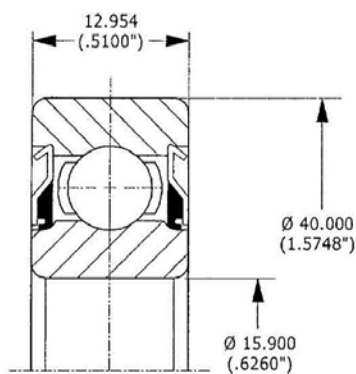
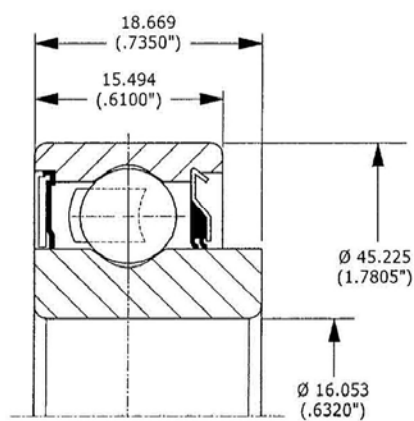
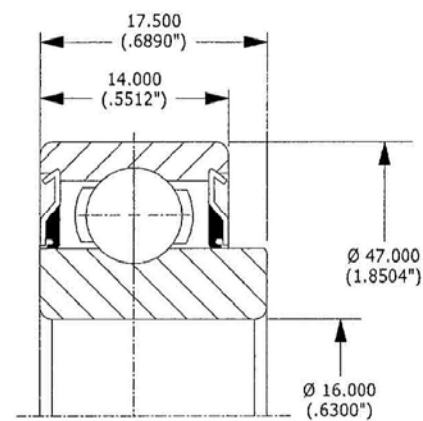

202NPP9

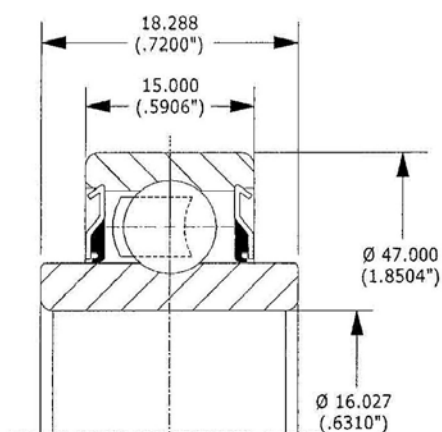
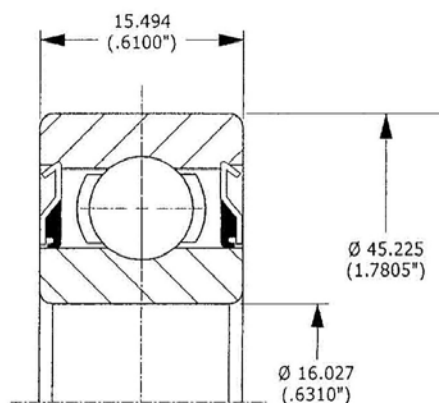
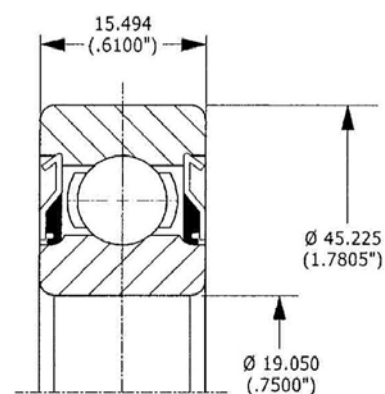
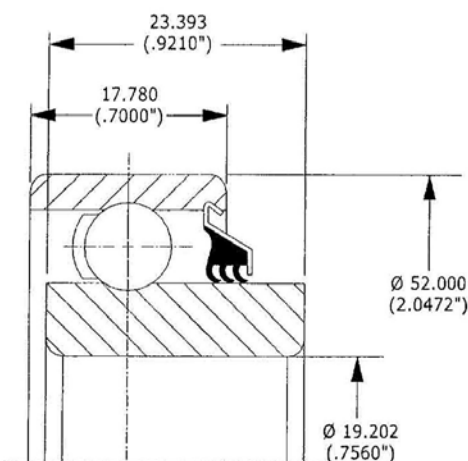
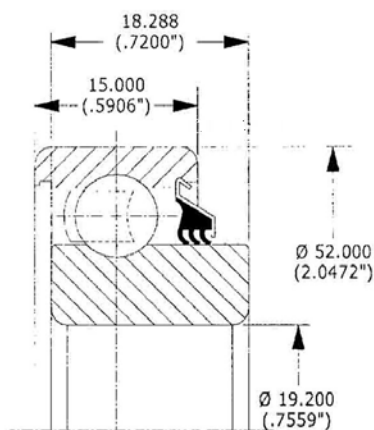
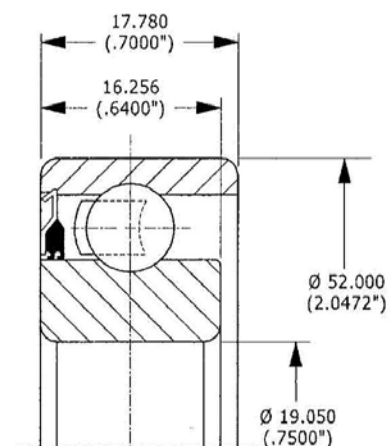
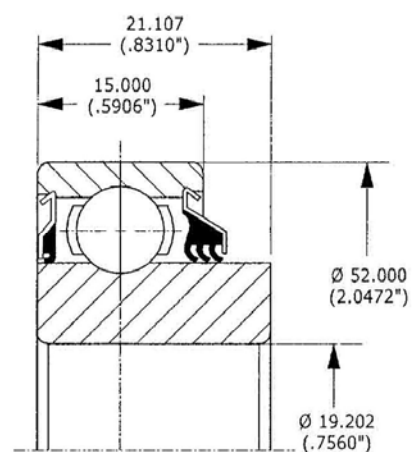
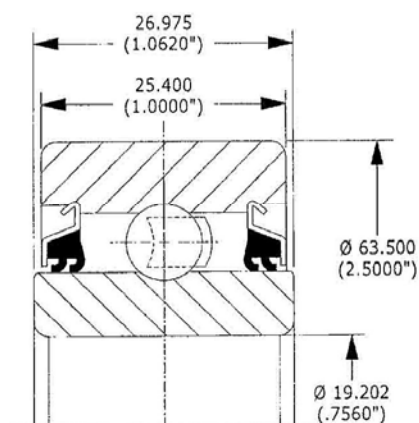
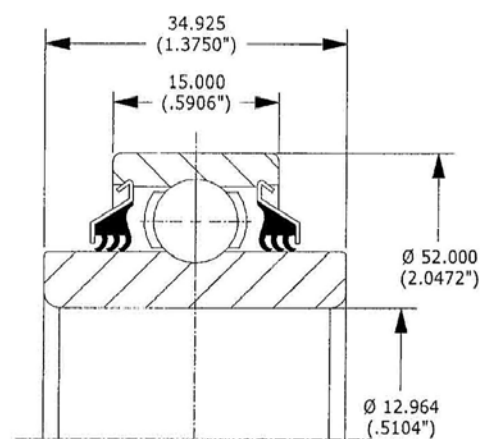
CF5202-2RST-8

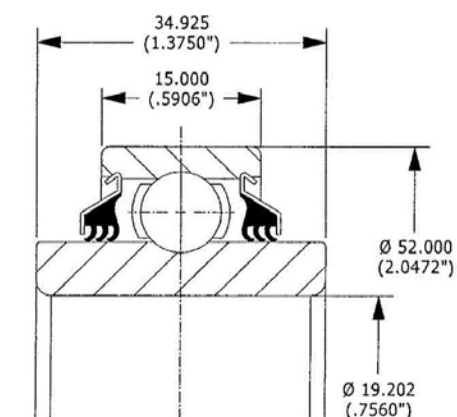
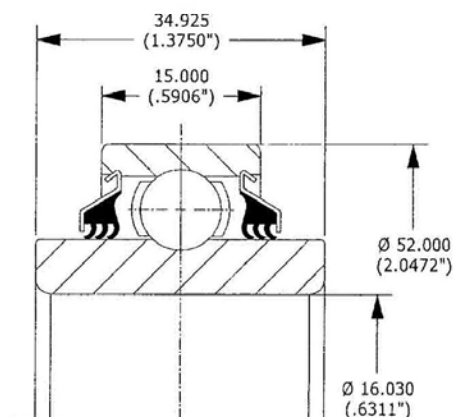
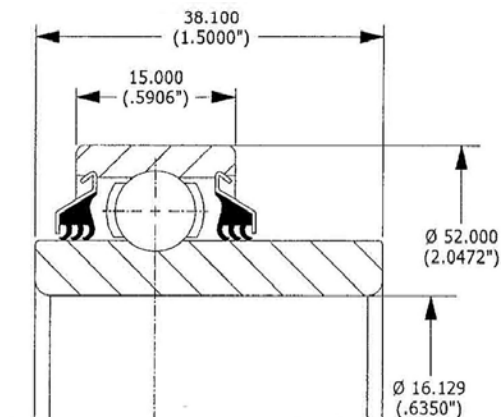
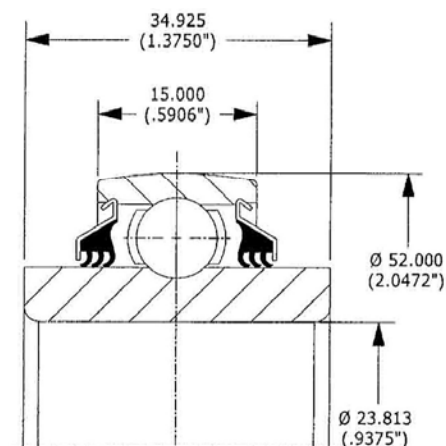
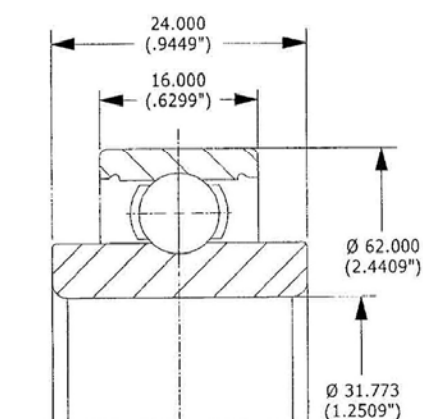
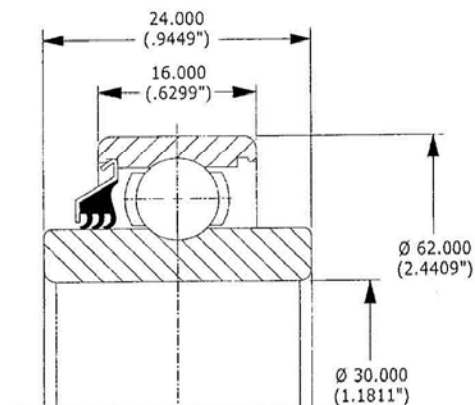
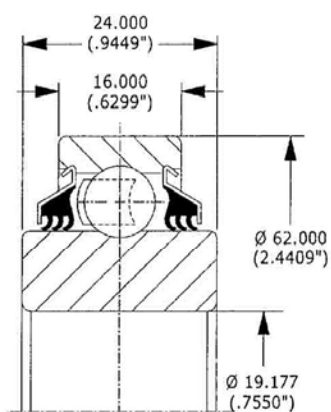
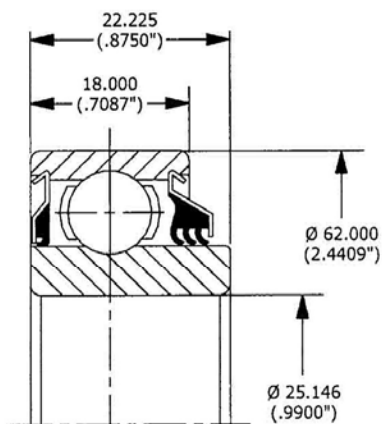
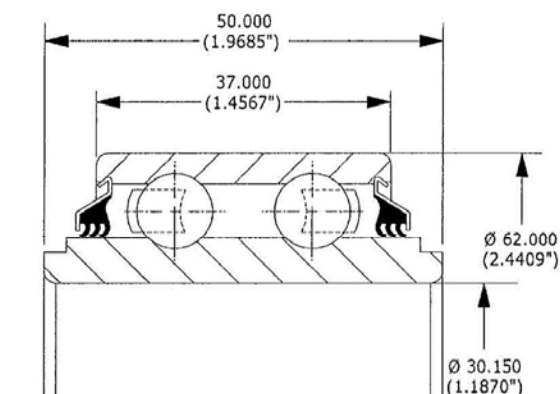
5203KYY2

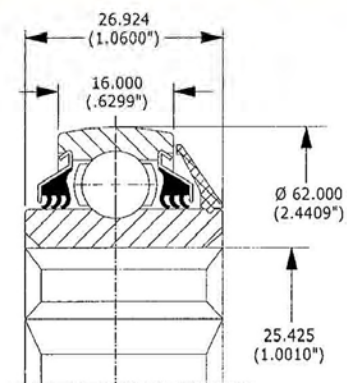
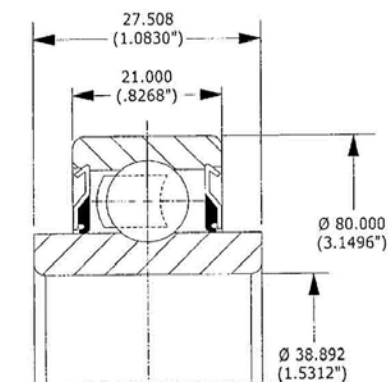
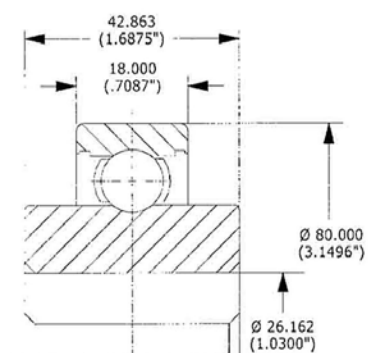
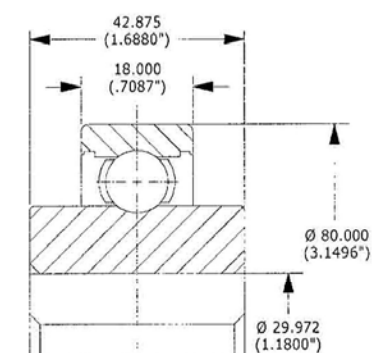
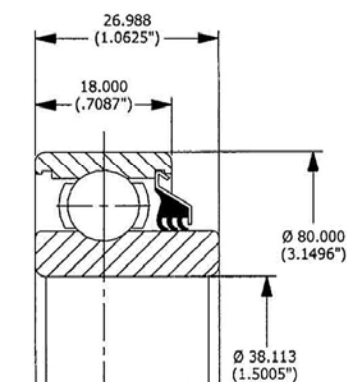
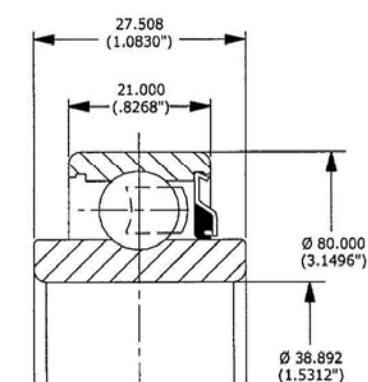
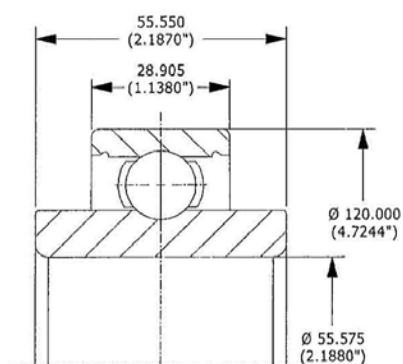
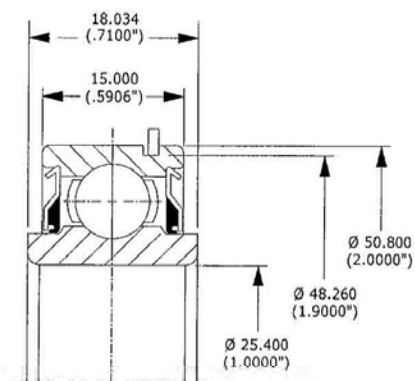
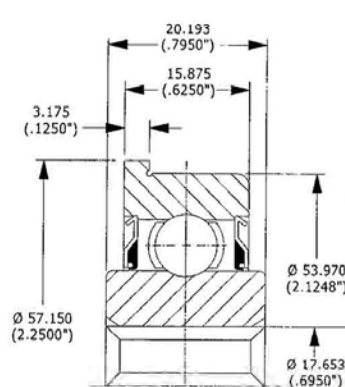
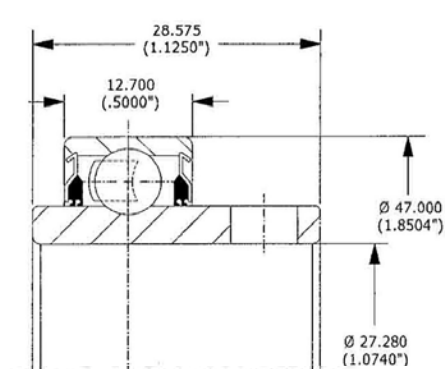
203JD

203KRR3

203KRR6

203NPP9

204JY3

204KRD4

**204KRR14****204RR8****Z9504-2RST****205KP6****205KP8****205KR3****205KRP2****205KYY3****205PP8**

205PP9

205PP10

205PP12

205PPB7

206K14

206KP2

206KPP16

206KRP4

5206KPP3

**206KPPB5****207KRR14****207KYY****208KRR4****W208K2****W208K3****208KP2****208KR4****W213-8445****X365****RX84****FHRL6005-BB9105**





INDUSTRIES
BEARINGS & COMPONENTS

AGRI HUB *CUSCINETTI PER FRANGIZOLLE*



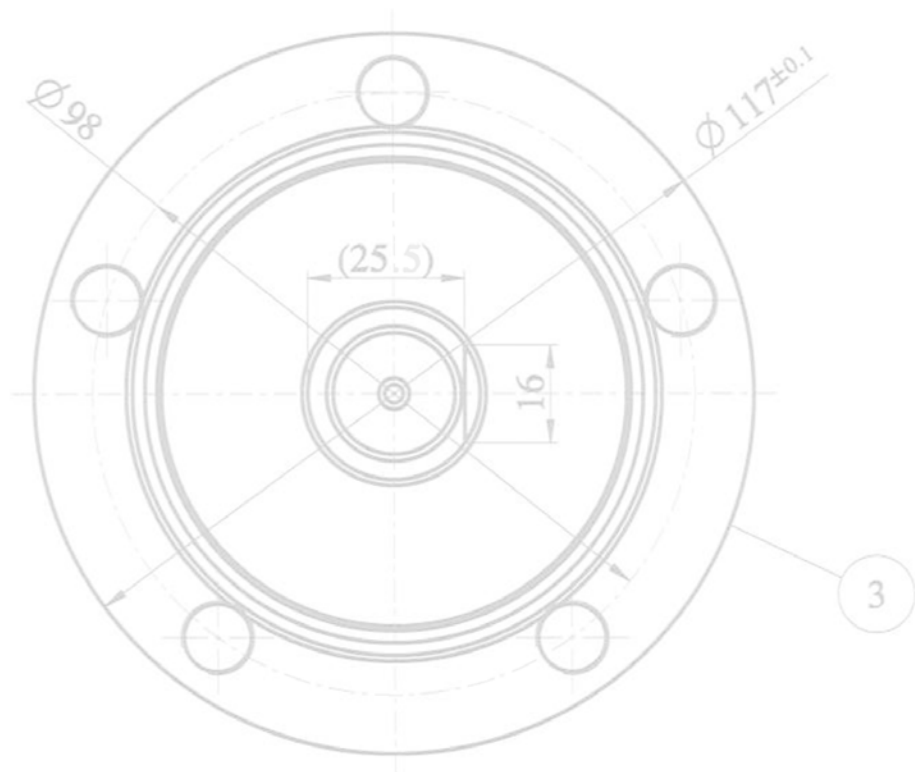

SECTION E-E

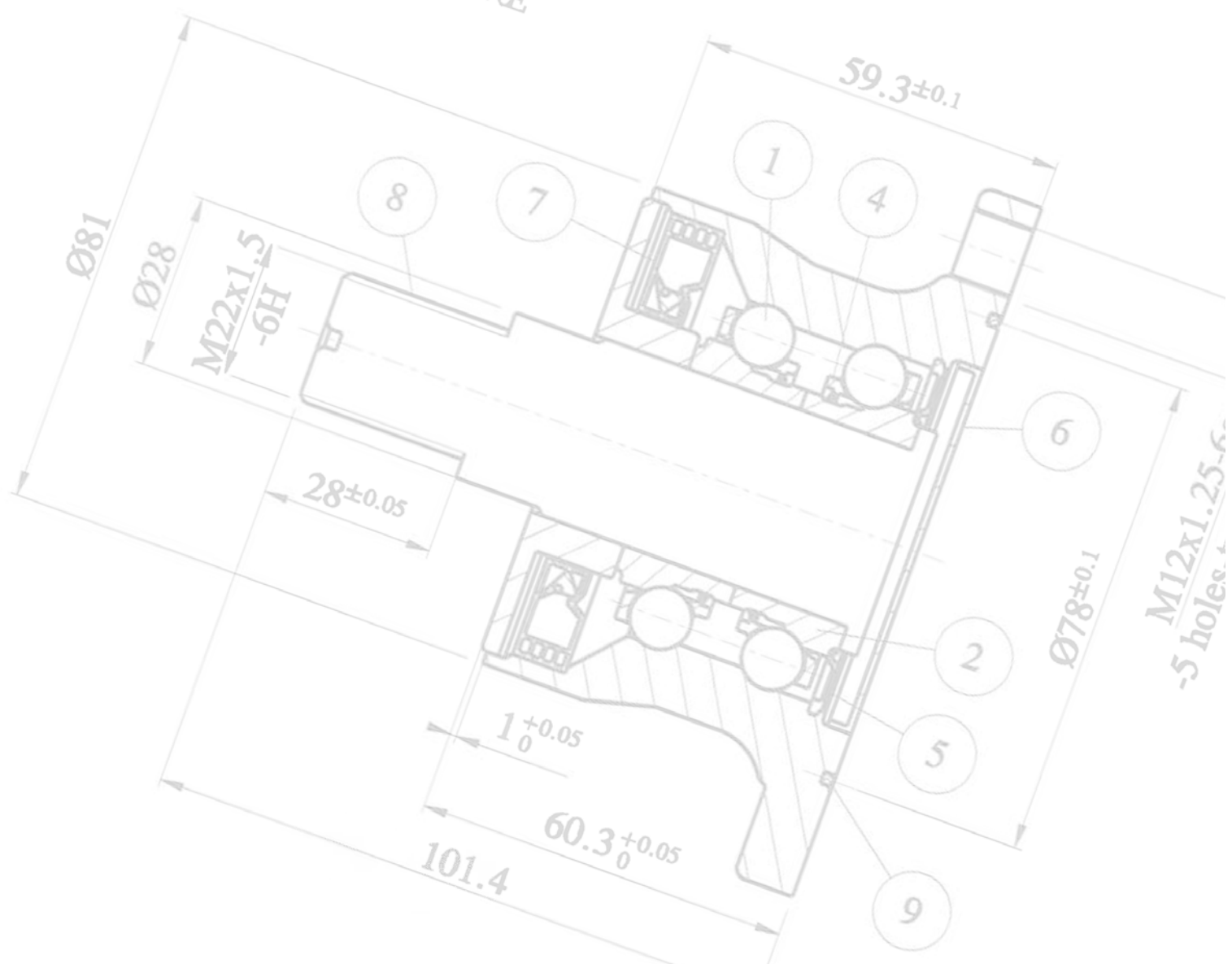



The ISB Agri Hub offers a virtually maintenance-free, unitized, sealed bearing unit with vital advantages for both end users and original equipment manufacturers.

Greased and sealed for life, the ISB Agri Hub reduces grease usage and the potential for grease spillage. Due to its high stiffness, the risk for disc tilt is minimized and machine reliability is further improved.

MAIN CHARACTERISTICS

- Anti contamination cap for disc replacement
- High performance sealing to prevent water, snow, mud, dust ingress
- Anti string system flange shape
- High capacity bearing with rigid design to withstand stock loads
- Anti straw, dust and stones labyrinth
- Plating corrosion resistant to jet cleaning and fertilizers

OEM BENEFITS

- Cut warranty, engineering, testing and assembly costs
- Increase product quality/reliability
- Differentiate designs
- Support sustainability efforts

END-USER BENEFITS:

- Increase bearing unit service life
- Reduce maintenance and ownership costs
- Install or replace quickly and easily
- Improve productivity

I cuscinetti per frangizolle ISB sono unità cuscinetto con tenuta incorporata e praticamente a manutenzione zero, in grado di garantire straordinari vantaggi sia agli utenti che agli OEM.

Ingrassate e lubrificate a vita, le unità Agri Hub garantiscono una riduzione del consumo (risparmio del 90%) e delle potenziali perdite di grasso.

CARATTERISTICHE PRINCIPALI

- Sistema di protezione da paglia, polvere ed urti di pietre
- Tenute per evitare infiltrazioni di acqua, neve, fango, polvere
- Rivestimento anti-corrosione resistente alla pulizia del getto e dei fertilizzanti
- Elevata resistenza ai carichi d'urto
- «Tappo anti contaminazione» che permette la sostituzione del disco
- Forma della flangia con sistema «anti-sterzo»

VANTAGGI PER OEM

- Abbattimento dei costi di garanzia, di progettazione, di collaudo e di montaggio
- Aumento della qualità/affidabilità dei prodotti
- Design diversificati
- Impegno a favore della sostenibilità

VANTAGGI PER UTENTI FINALI

- Aumento della durata di esercizio dei cuscinetti
- Riduzione dei costi di manutenzione e proprietà
- Installazione o sostituzione semplice e rapida
- Ottimizzazione della produttività

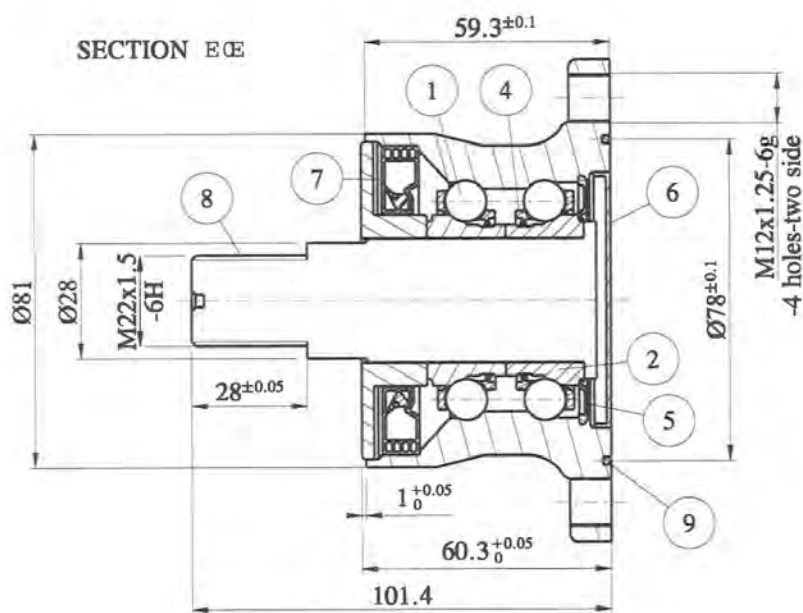
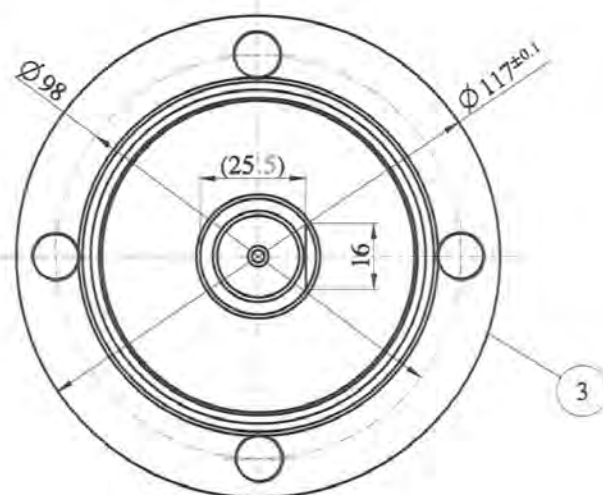

N°	Part Componente	Quantity Quantità	Material Materiale
1	Balls / Sfera	12x2	100Cr6
2	Inner Ring / Anello Interno	2	100Cr6
3	Outer Ring / Anello Esterno	1	Steel / Acciaio
4	Cage / Gabbia	2	PA66
5	Seal / Tenuta	1	NBR+Steel / NBR+Acciaio
6	Cover Board / Coperchio	1	Steel / Acciaio
7	Seal / Tenuta	1	NBR+Steel / NBR+Acciaio
8	Shaft / Albero	1	Steel / Acciaio
9	O-Ring / Anello di tenuta	1	NBR

Radial clearance Gioco radiale	Rated load Carico nominale	Grease quantity Quantità di grasso
[mm]	[kW]	
0,005 ÷ 0,025	Cr: 46,84 Cor: 36,66	7 ÷ 10,5

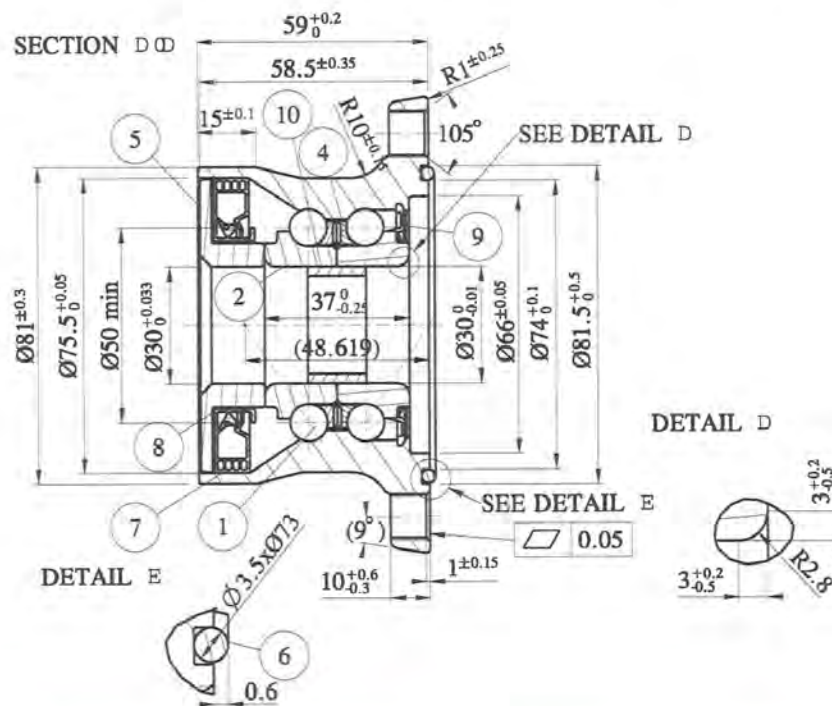
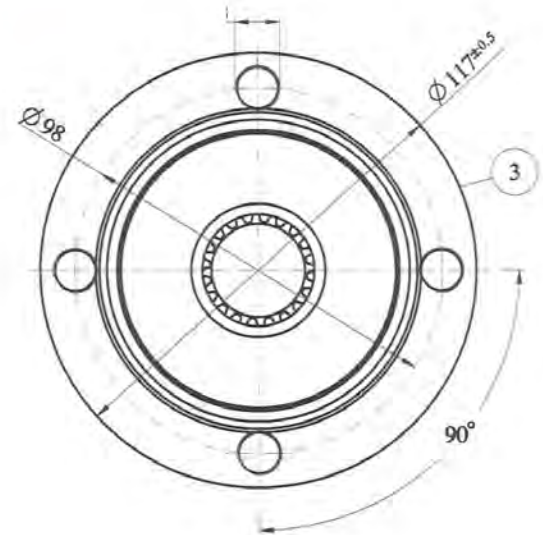

N°	Part Componente	Quantity Quantità	Material Materiale
1	Balls / Sfere	14x2	100Cr6
2	Inner Ring / Anello Interno	2	100Cr6
3	Outer Ring / Anello Esterno	1	100Cr6
4	Cage / Gabbia	2	PA66
5	Cover Board / Coperchio	1	Steel / Acciaio
6	O-Ring / Anello di tenuta	1	NBR
7	Seal / Tenuta	1	NBR+Steel / NBR+Acciaio
8	Seal / Tenuta	1	NBR+Steel / NBR+Acciaio
9	Seal / Tenuta	1	
10	Sleeves / Bussola	1	PA66

Radial clearance Gioco radiale	Rated load Carico nominale	Grease quantity Quantità di grasso
[mm]	[kW]	
0,005 ÷ 0,030	Cr: 36,3 Cor: 31,6	7 ÷ 10,5

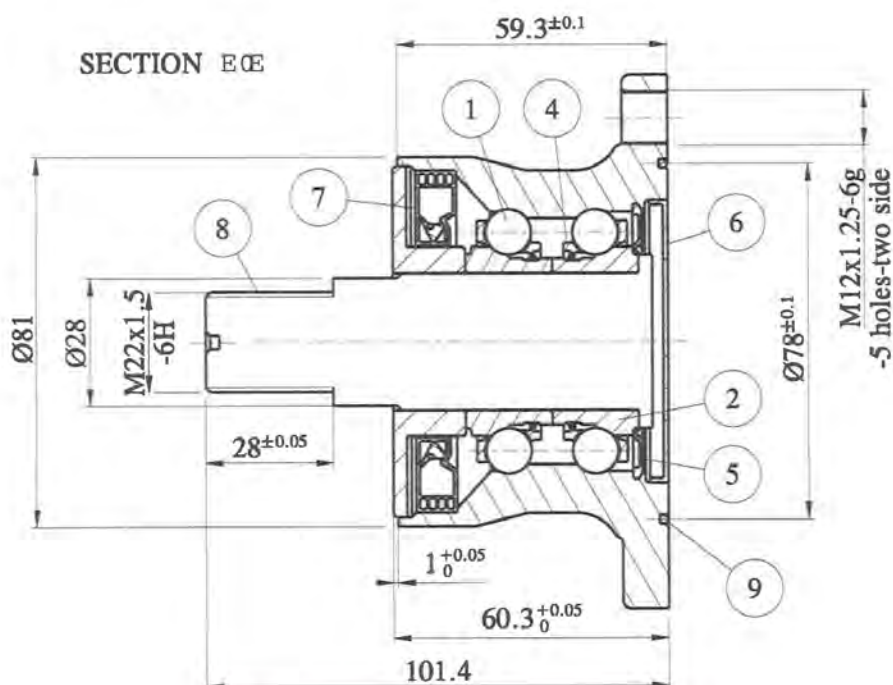
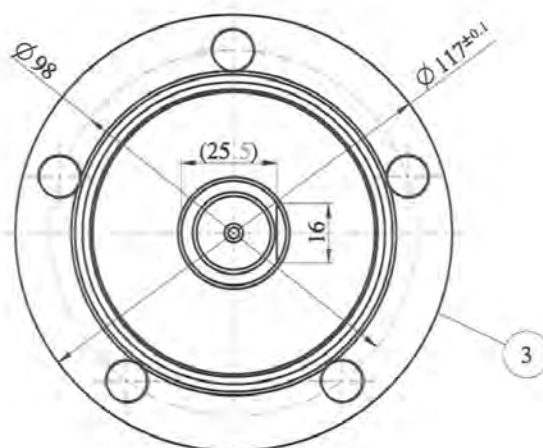

N°	Part Componente	Quantity Quantità	Material Materiale
1	Balls / Sfere	12x2	100Cr6
2	Inner Ring / Anello Interno	2	100Cr6
3	Outer Ring / Anello Esterno	1	Steel / Acciaio
4	Cage / Gabbia	2	PA66
5	Seal / Tenuta	1	NBR+Steel / NBR+Acciaio
6	Cover Board / Coperchio	1	Steel / Acciaio
7	Seal / Tenuta	1	NBR+Steel / NBR+Acciaio
8	Shaft / Albero	1	Steel / Acciaio
9	O-Ring / Anello di tenuta	1	NBR

Radial clearance Gioco radiale	Rated load Carico nominale	Grease quantity Quantità di grasso
[mm]	[kW]	
0,005 ÷ 0,025	Cr: 46,84 Cor: 36,66	7 ÷ 10,5

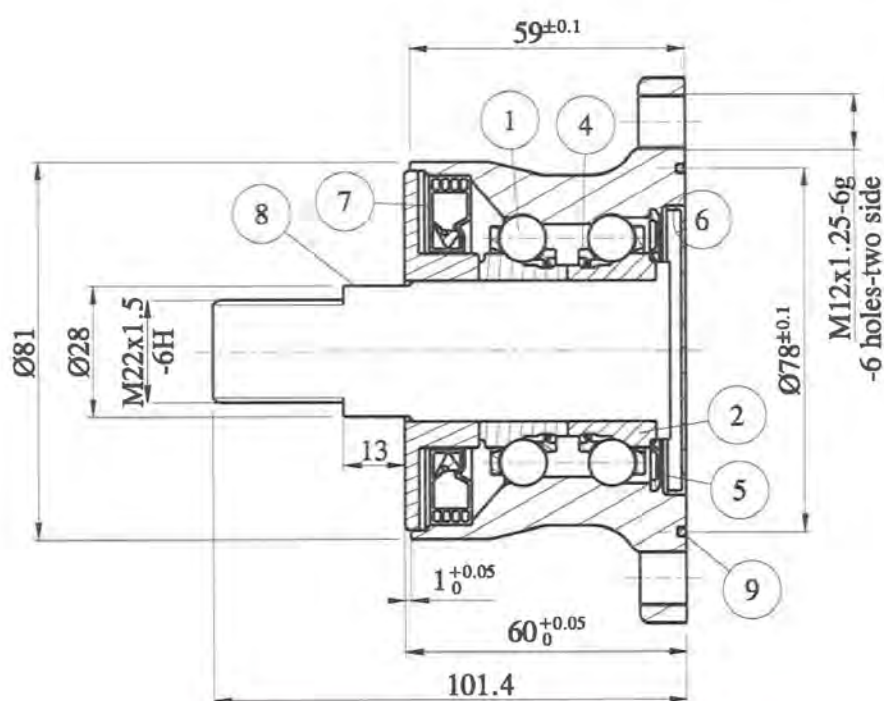
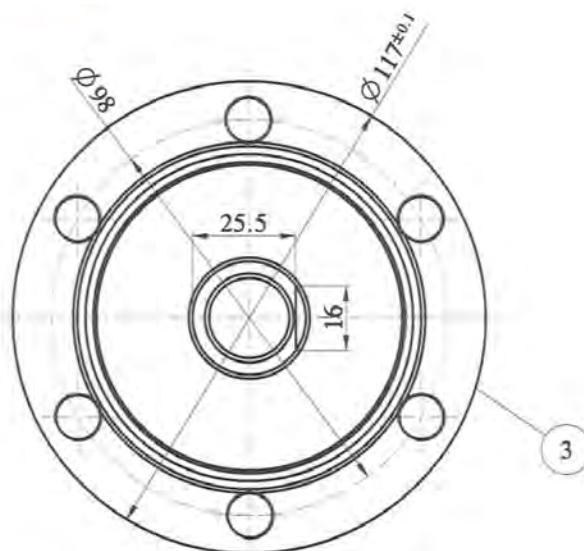

N°	Part Componente	Quantity Quantità	Material Materiale
1	Balls / Sfere	12x2	100Cr6
2	Inner Ring / Anello Interno	2	100Cr6
3	Outer Ring / Anello Esterno	1	Steel / Acciaio
4	Cage / Gabbia	2	PA66
5	Seal / Tenuta	1	NBR+Steel / NBR+Acciaio
6	Cover Board/ Coperchio	1	Steel / Acciaio
7	Seal / Tenuta	1	NBR+Steel / NBR+Acciaio
8	Shaft / Albero	1	Steel / Acciaio
9	O-Ring / Anello di tenuta	1	NBR

Radial clearance Gioco radiale	Rated load Carico nominale	Grease quantity Quantità di grasso
[mm]	[kW]	
0,005 ÷ 0,025	Cr: 46,84 Cor: 36,66	7 ÷ 10,5





INDUSTRIES
BEARINGS & COMPONENTS

AGRICULTURAL SLEWING BEARINGS

RALLE AGRICOLE



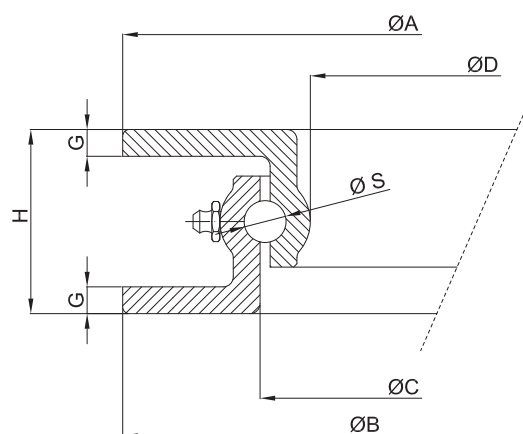

ISB Code Codice ISB	ØA	ØB	ØC	ØD	H	G	ØS	Axial Capacity Portata assiale	Weight Peso
	±5	±5	±5	±5	±3				
	[mm]	[mm]	[mm]	[mm]	[mm]				
AG.0300.55	300	300	225	200	55	8	12,5	500	5
AG.0400.55	400	400	321	300	55	8	12,5	750	7
AG.0500.55	500	500	421	400	55	8	12,5	1000	9
AG.0500.65	500	500	410	388	65	9	12,5	1000	15
AG.0600.65	600	600	510	486	65	9	12,5	1500	20
AG.0650.65	650	650	560	536	65	9	12,5	1600	22
AG.0700.65	700	700	610	587	65	9	14	2000	24
AG.0750.65	750	750	660	636	65	9	14	2100	26
AG.0800.65	800	800	710	688	65	9	14	2500	27
AG.0850.65	850	850	760	728	65	9	14	3000	29
AG.0900.65	900	900	810	786	65	9	14	3500	32
AG.0950.65	950	950	860	837	65	9	14	3500	33
AG.1000.65	1000	1000	910	888	65	9	14	4000	35
AG.1050.65	1050	1050	960	938	65	9	14	4500	37
AG.1100.65	1100	1100	1010	988	65	9	14	4500	40

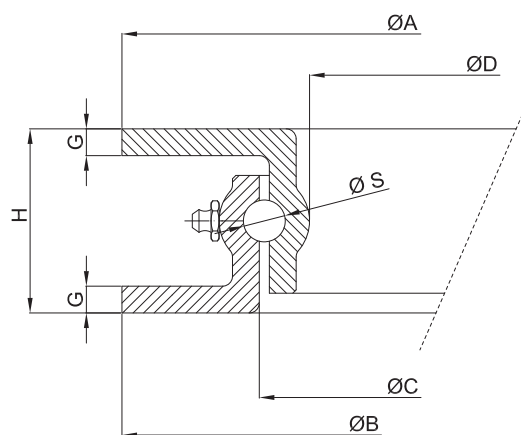

ISB Code Codice ISB	ØA	ØB	ØC	ØD	H	G	ØS	Axial Capacity Portata assiale	Weight Peso
	±5	±5	±5	±5	±3				
	[mm]	[mm]	[mm]	[mm]	[mm]				
AGR.0300.55	300	315	240	215	55	8	1/2"	500	7
AGR.0400.55	400	415	340	310	55	8	1/2"	750	10,3
AGR.0500.55	500	515	440	415	55	8	1/2"	1000	12,5
AGR.0530.55	530	545	470	445	55	8	1/2"	1100	13,5
AGR.0600.55	600	590	528	500	55	8	1/2"	1500	16
AGR.0700.55	700	700	620	595	55	8	1/2"	2000	17
AGR.0745.55	745	745	670	645	55	8	1/2"	2200	20
AGR.0800.55	800	800	720	695	55	8	1/2"	2500	23
AGR.0850.55	850	850	770	745	55	8	1/2"	3000	25
AGR.0800.70	800	800	705	680	70	8	1/2"	2500	28
AGR.0900.70	900	900	800	775	70	8	1/2"	3500	32
AGR.0950.70	950	945	850	825	70	8	9/16"	4000	35
AGR.1000.70	1000	1000	905	875	70	8	9/16"	4500	37
AGR.1050.70	1050	1050	955	925	70	8	9/16"	5000	40
AGR.1100.70	1100	1100	1000	975	70	8	5/8"	6000	41
AGR.1200.70	1200	1190	1095	1075	70	8	5/8"	10000	45
AGR.1000.80	1000	1015	900	875	80	8	5/8"	6000	41
AGR.1100.80	1100	1100	1000	970	80	8	5/8"	8000	45
AGR.1090.90	1090	1090	980	955	90	8	5/8"	8000	46
AGR.1200.90	1200	1200	1085	1055	90	8	5/8"	8500	56
AGR.1100.90	1100	1110	985	955	90	10	7/8"	10000	60
AGR.1200.90	1200	1205	1090	1045	90	10	7/8"	12000	70

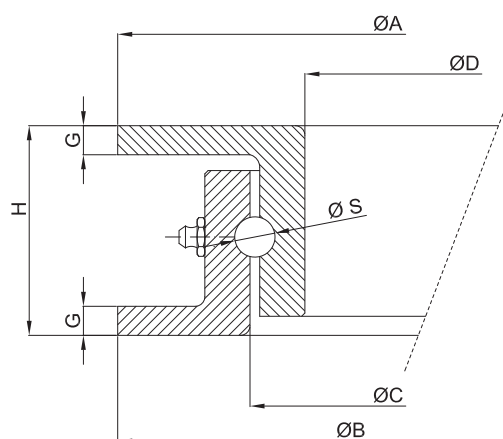

ISB Code <i>Codice ISB</i>	ØA	ØB	ØC	ØD	H	G	ØS	Axial Capacity <i>Portata assiale</i>	Weight <i>Peso</i>
	±5	±5	±5	±5	±3				
	[mm]	[mm]	[mm]	[mm]	[mm]				
ST.0200.45	200	200	150	130	45	8	1/2"	200	5
ST.0300.50	300	300	240	215	50	8	1/2"	300	9,9
ST.0400.55	400	400	325	305	55	6	1/2"	400	10,3



©Copyright 

The reproduction, even partial, of the contained concerning this technical catalogue, is forbidden. Liability for possible errors and/or omissions are not accepted. The measurements, drawings and images are not demanding. TM Registered in Italy-EU.

È vietata la riproduzione anche parziale del contenuto di questo catalogo tecnico. Non si possono accettare responsabilità per eventuali errori od omissioni. Le misure, i disegni e le immagini non sono impegnativi. Marchio registrato Italia-EU.



I N D U S T R I E S
B E A R I N G S & C O M P O N E N T S



01.10.2018 ©Copyright 



700003878E44A26101708



MISTO
Carta da fonti gestite
in maniera responsabile
FSC® C101645